

Installation instructions

For professional use

EN

www.stuv.com

You can also find us on:

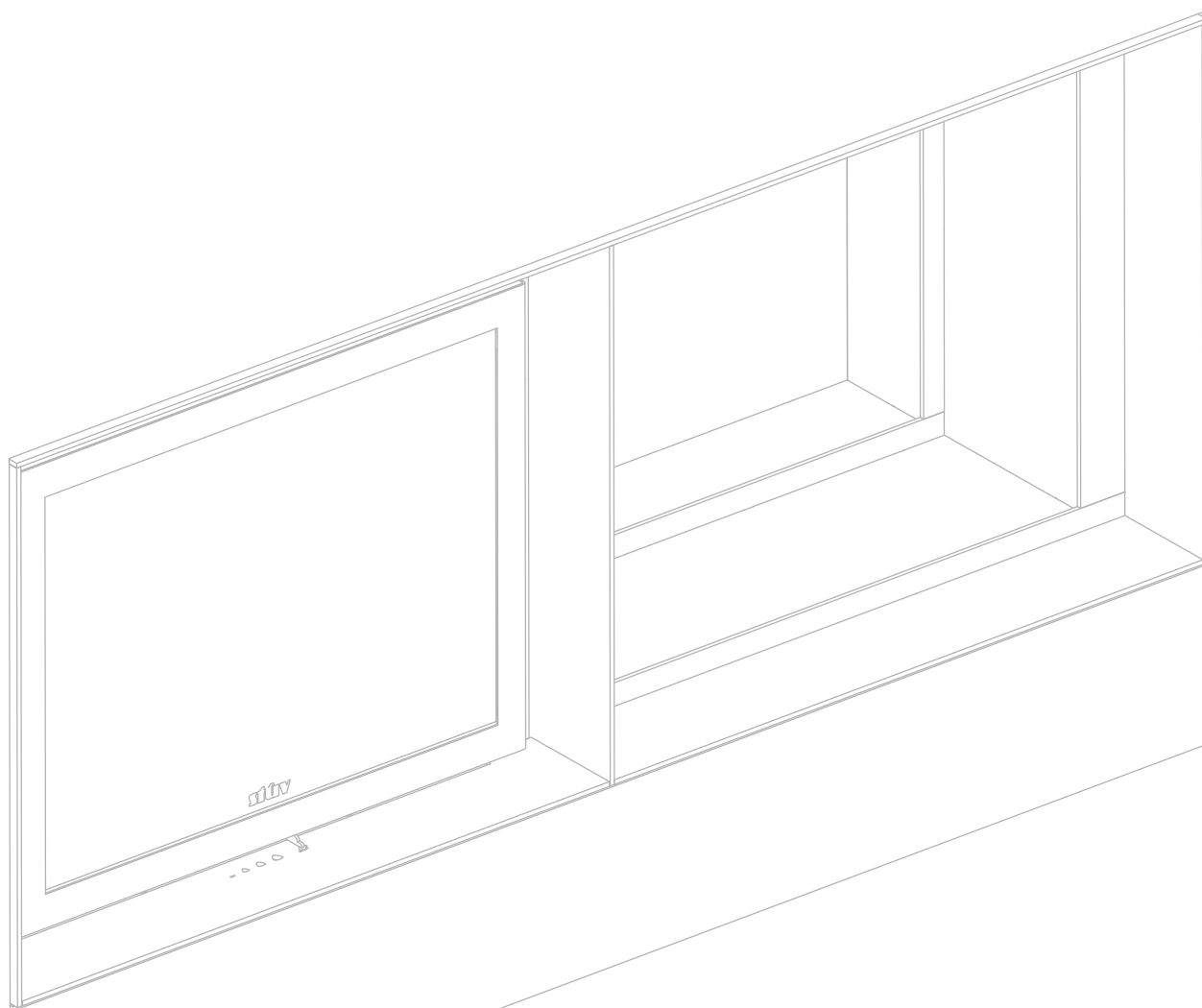

stuv₁₆

D4 Frame

April 2021

93109162

This cladding has been designed to offer maximum pleasure comfort and safety.

The greatest care has been taken during the manufacturing process. If you still have any problems, please contact your distributor.

We recommend that you read these instructions before beginning installation.

Certain configurations may need the steps to be taken in a different order.

Contents

GENERAL	3
Recommendations	3
Precautions regarding surrounding materials	3
Compatibility	3
Maximum load in the niches	3
PREPARING THE AREA	4
Dimensions of the frame	4
Positioning the stove	4
Preparing the stove	5
Installation constraint - Insulation of the niche	6
Constructing the upper chamber	6
INSTALLING THE FRAME	7
Assembly	7
MAINTENANCE	11
CONTACTS	11

GENERAL

Recommendations

Please read the installation and usage instructions before installing and using the product.

You should also follow the recommendations for using your stove.

This Stûv cladding should be installed by a professional who has received the appropriate training from the Stûv manufacturer or one of its importers.

Once the cladding has been installed, hand over these instructions to the user.

Signature of the delivery note implies the recipient's acceptance and acknowledgement that the goods are the ones that were ordered. It is therefore important to check it thoroughly at the time of delivery.

Follow the maintenance instructions.

Any change made to the cladding may be dangerous. Please follow the specific instructions.

Installation of the stove, its accessories and the surrounds must comply with

all (local and national) regulations and all (national and European) norms.

Precautions regarding surrounding materials

The building materials around the device may reach temperatures of up to 85°. Please make sure that they can tolerate this temperature **both for their structural integrity and for the risk of dangerous emissions.**

It is essential that you comply with the maximum amount of wood to be burned per hour to prevent the device from overheating. This limit is provided in the installation instructions for the Stûv 22.

Follow the rules (local and national norms and regulations) for decompressing the chamber in which the device is installed.

Compatibility

The D4 frame is compatible with Stûv 16-in whose serial number is after:

97851

Maximum load in the niches

The niches of frames D4 are designed to support a maximum weight of:

70kg

PREPARING THE AREA

Dimensions of the frame

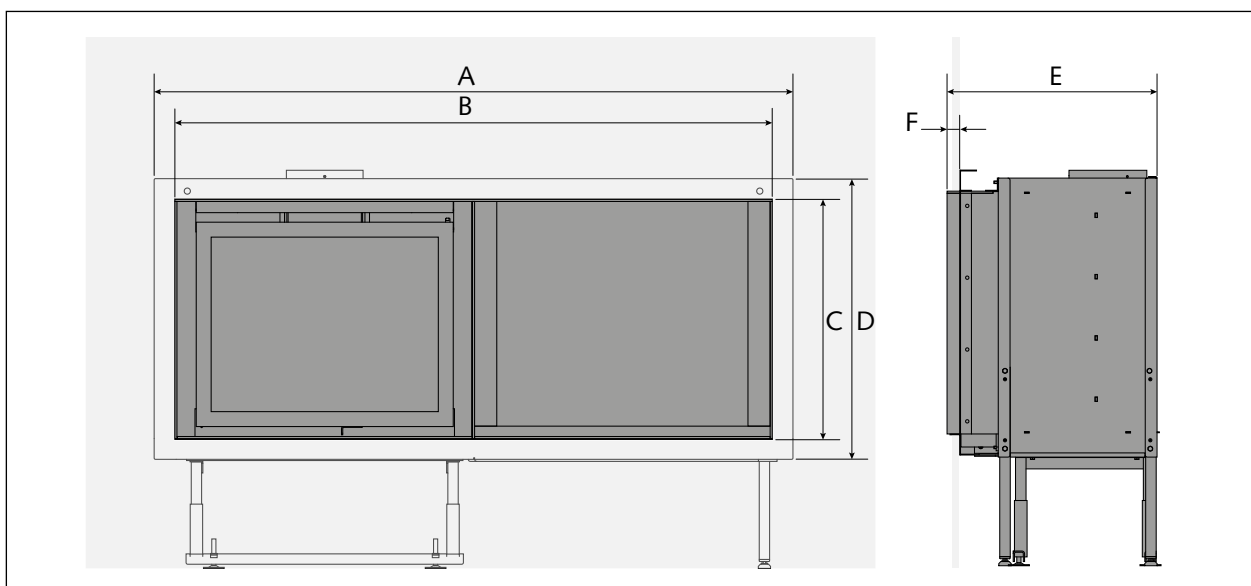

	16-58	16-68	16-78
A	1340	1540	1740
B	1240	1440	1640
C	577	577	577
D	677	677	677
E	500	500	500
F	30	30	30

Positioning the stove

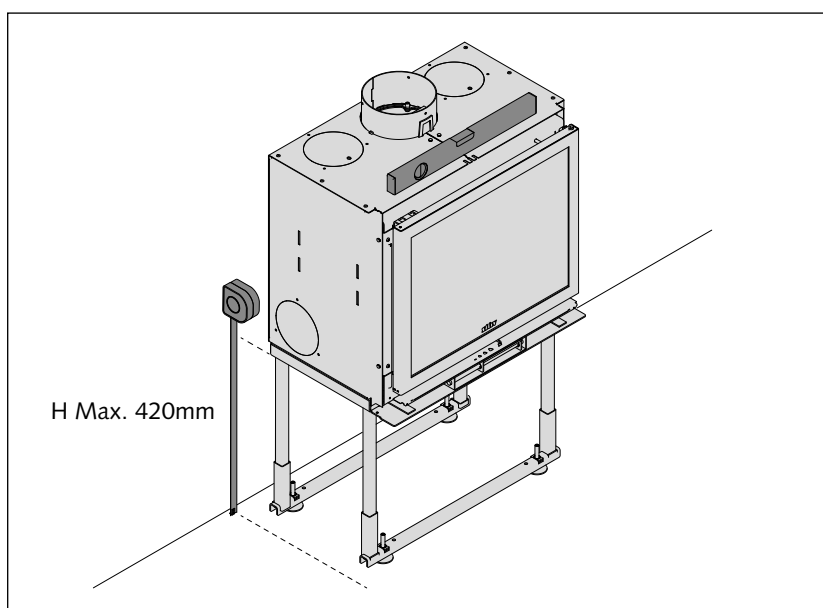

Before beginning the installation of the frame, make sure the fireplace is level in its final location and at the desired final height.

Refer to the documentation supplied with the appliance for the installation of the fireplace and its options and the connection.

Note: the niche legs allow the fireplace to be installed at a maximum height of 420mm from the floor. For installation at a higher height, plan to install the fireplace and the niche on masonry.

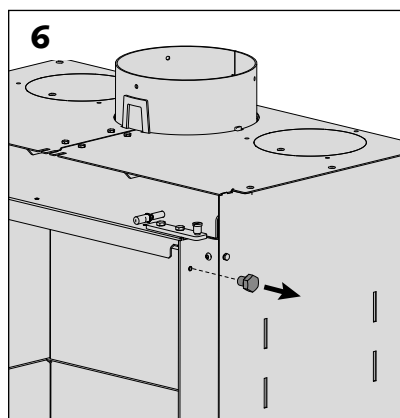
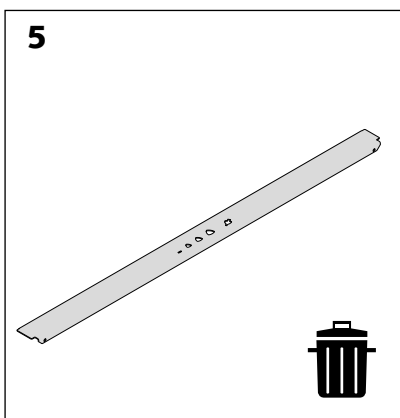
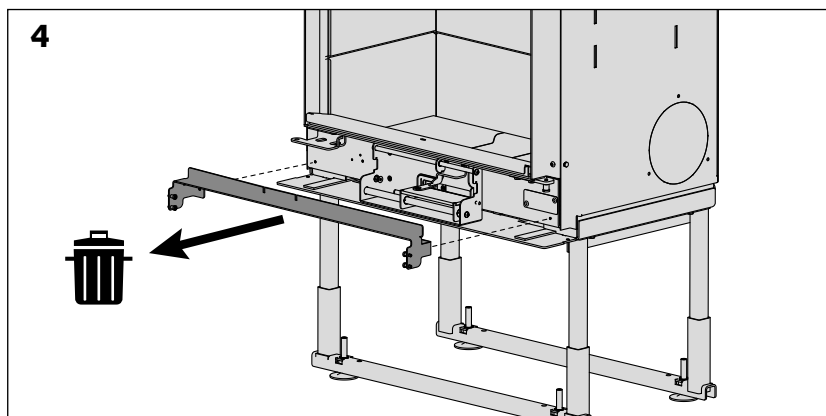
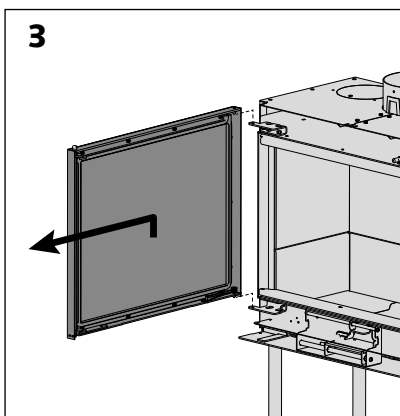
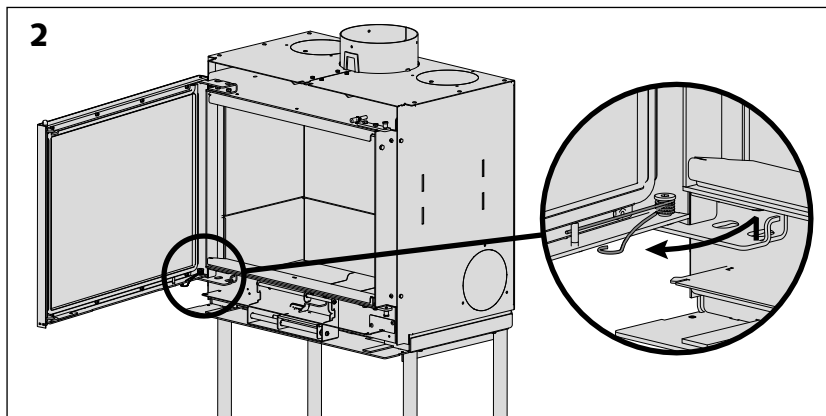
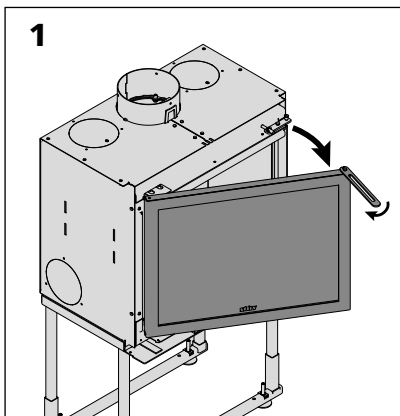

D4 frame is attached to the fireplace, just behind the door. The first step is therefore to dismantle the door [diagrams 1-3].

The reading tablet support and the reading tablet supplied with the fireplace will not be used [diagrams 4 & 5].

The pressure tap screw must be removed for the installation of the frame, **be sure to keep it [diagram 6].**

Installation constraint - Insulation of the niche

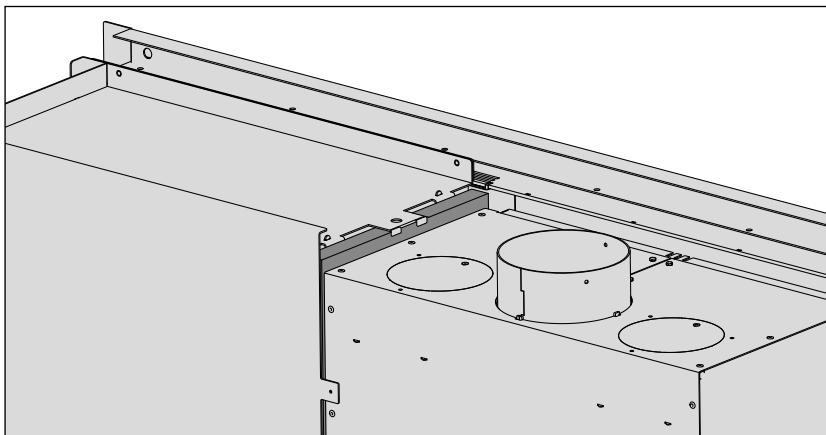

The niche of the D4 frame is supplied with insulation. This insulation allows the logs to be placed in the niche of the casing in complete safety.

Make sure that the insulation is present and in good condition before assembly.

Never assemble the casing without the insulation!

Constructing the upper chamber

 The upper chamber should be constructed after the device and cladding have been installed.

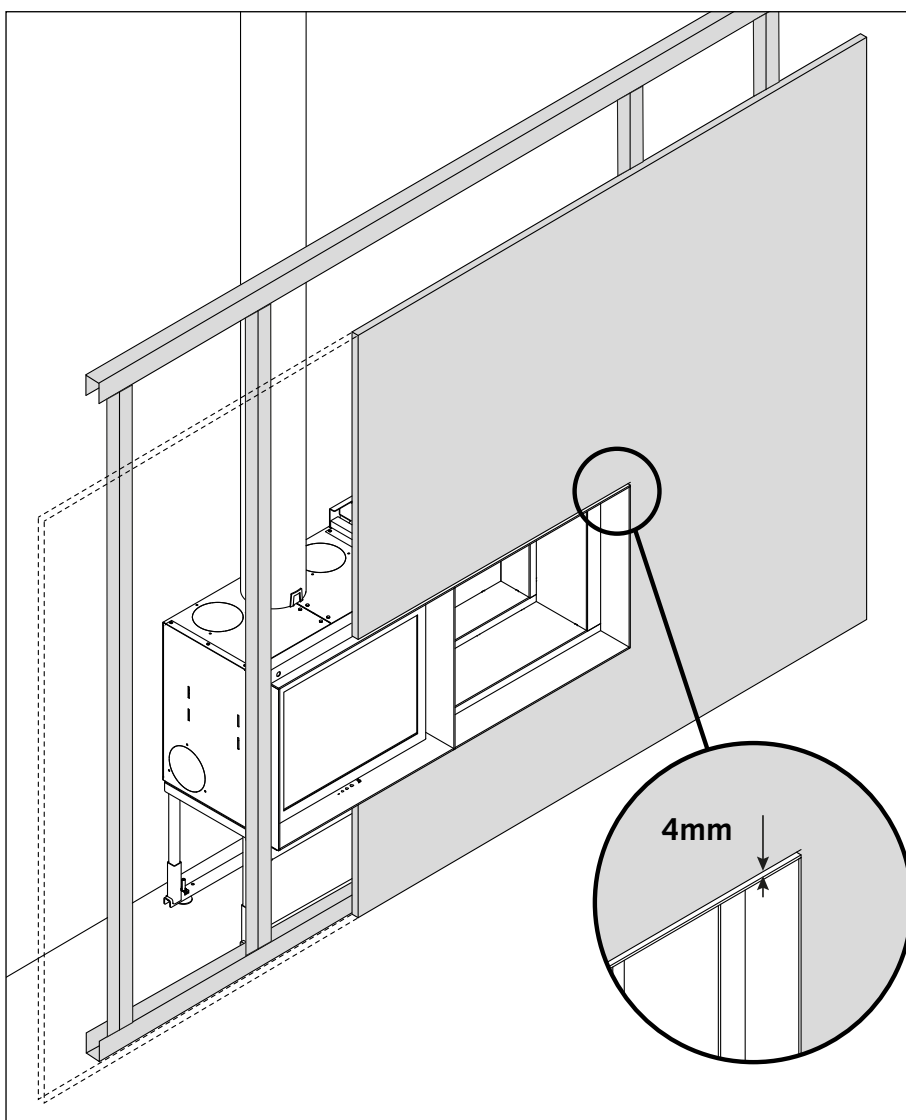

> The weight of the chamber must not rest on the top shelf of the cladding.

> Stûv recommends building a chamber made of metal sections and panels hanging from the ceiling and the wall.

> Make sure you have a 4mm recessed joint between the frame and the wall

> Follow the rules (local and national norms and regulations) for decompressing and ventilating the chamber in which the device is installed.

INSTALLING THE FRAME

Screws needed



A
X 4
ISO M5x12
52105006



B
X 2
ISO M4x8
52123001

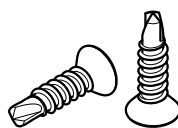

C
X 6
25mm
52122005

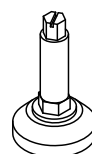

D
X 2
52114009

Assembly

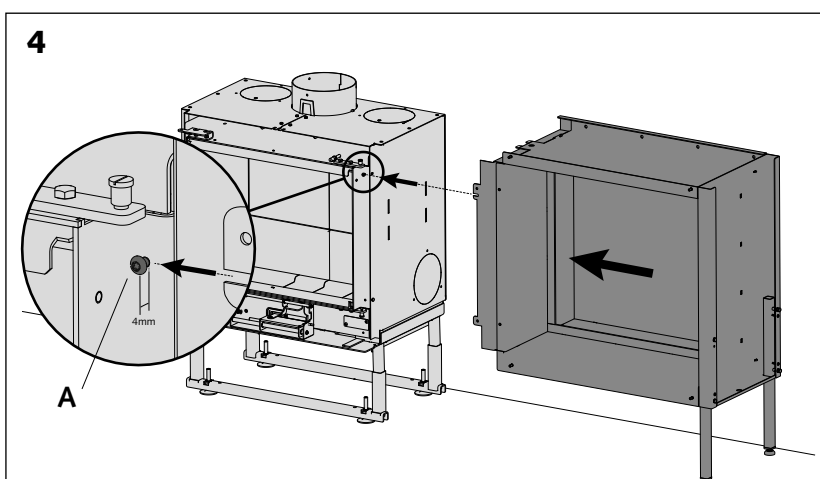
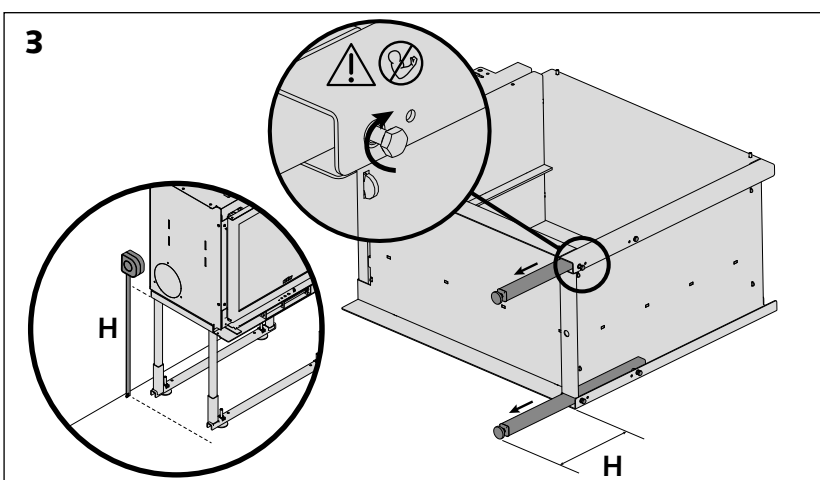
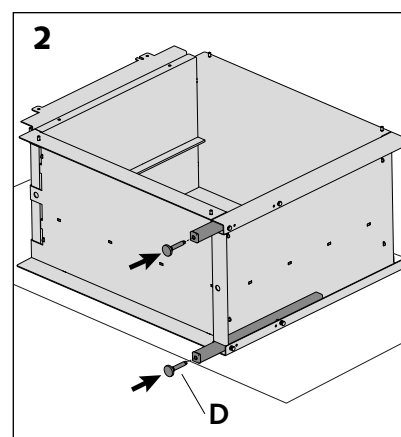
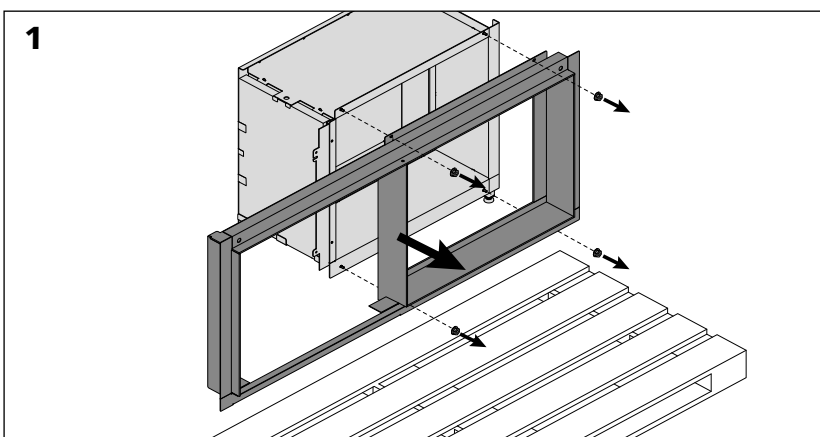

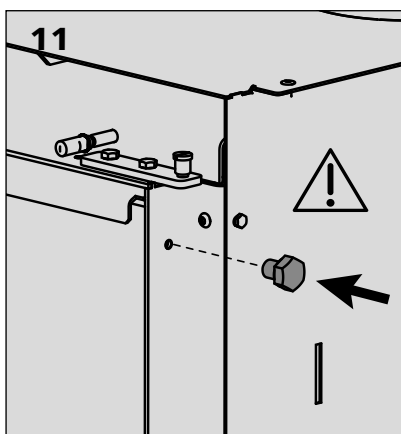
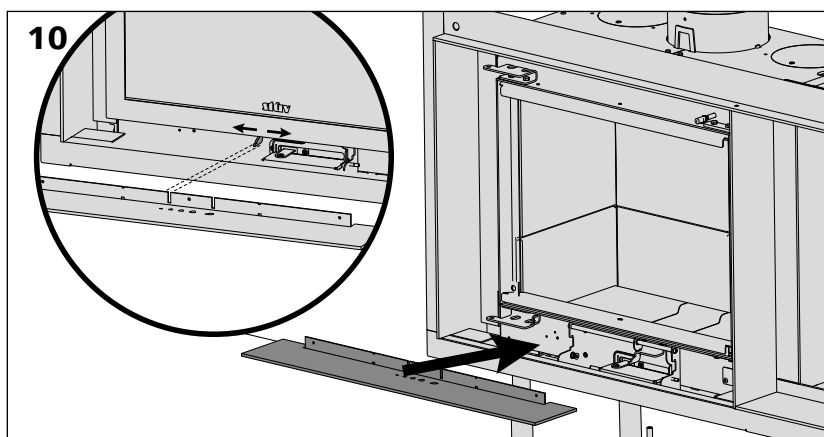
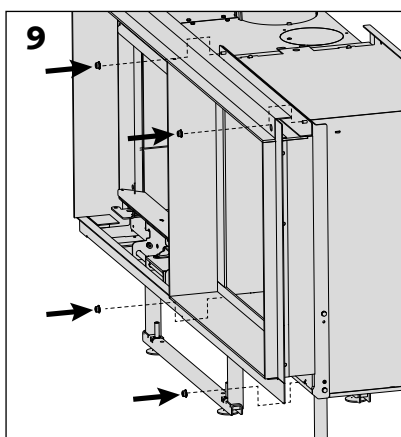
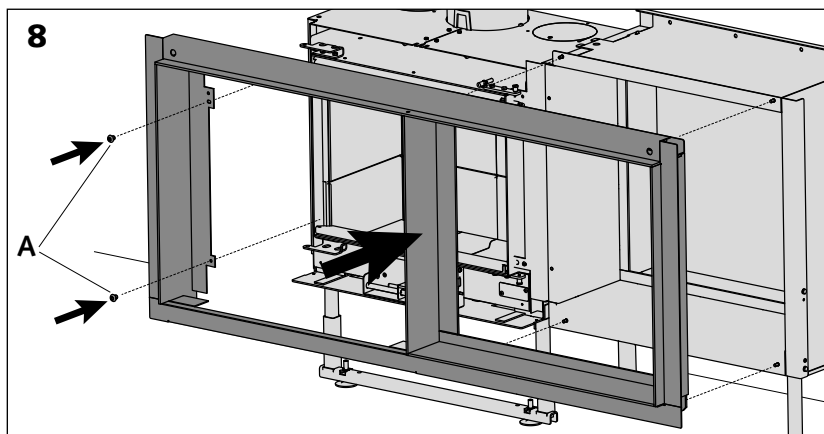
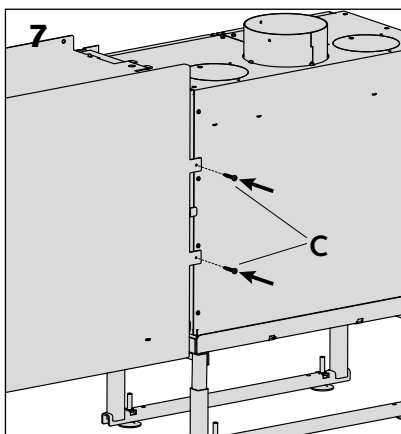
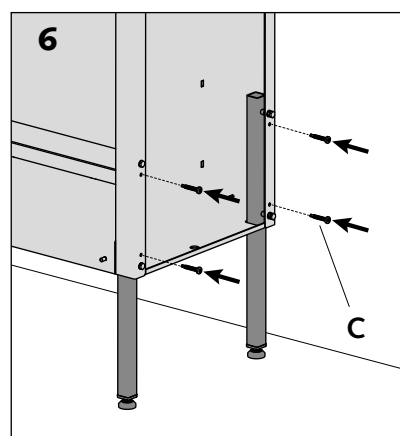
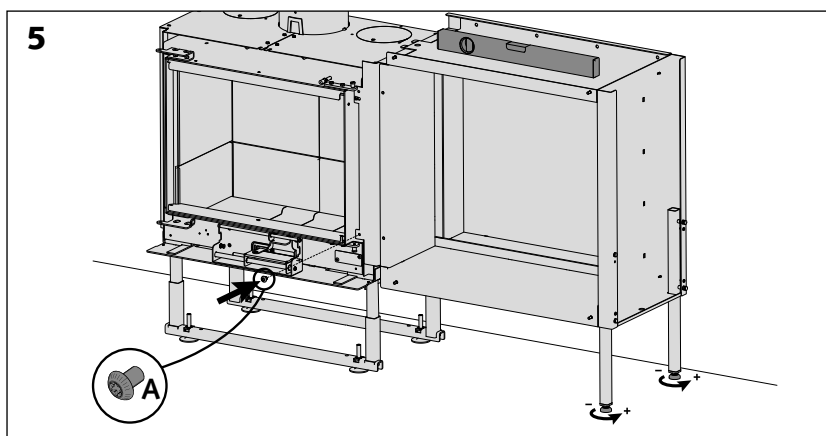

Warning

Replace the previously removed pressure take-off screw [diagram 11].

1

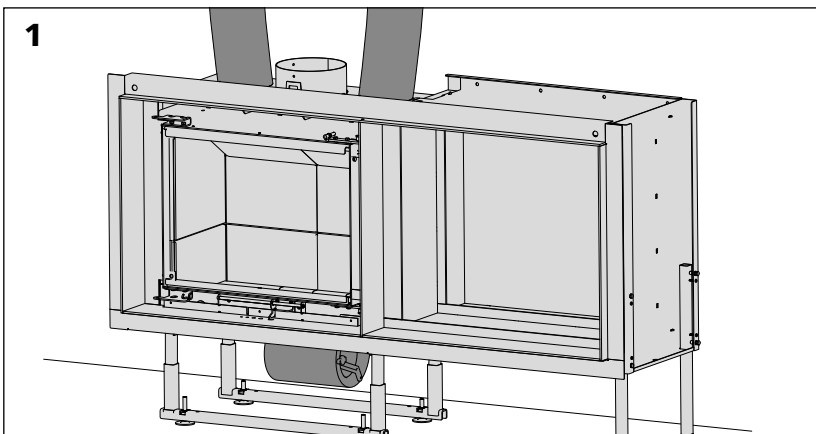

2

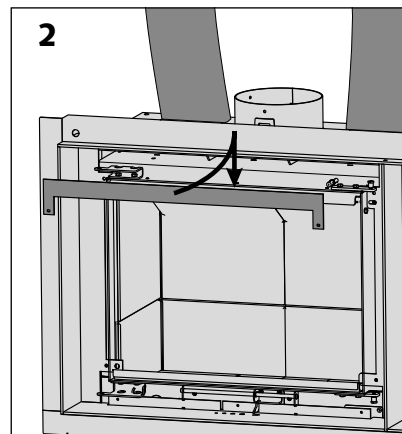

3

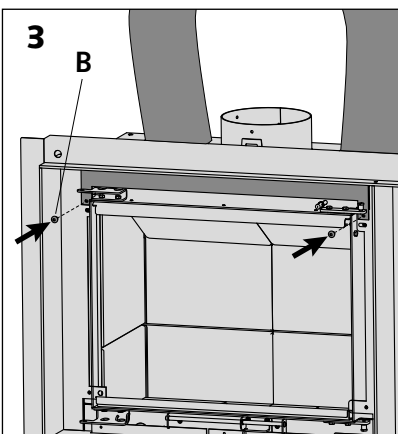

For installations which plan to channel hot convection air [diagram 1], it is necessary to place the deflection plate in front of the unit's convection outlet [diagram 2 & 3].

12

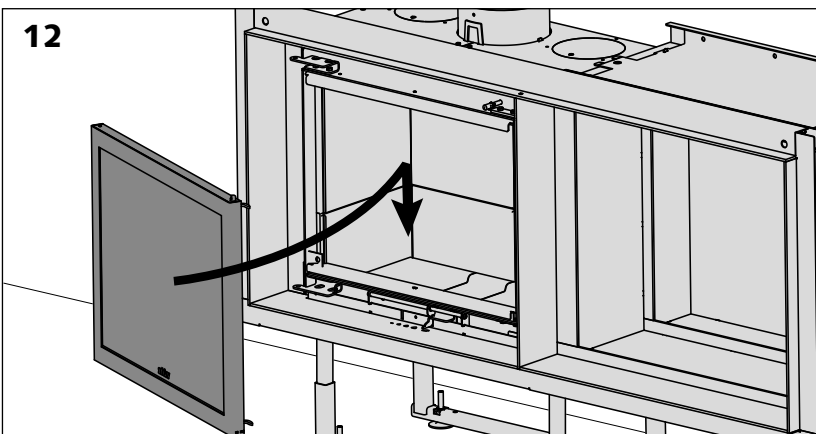

13

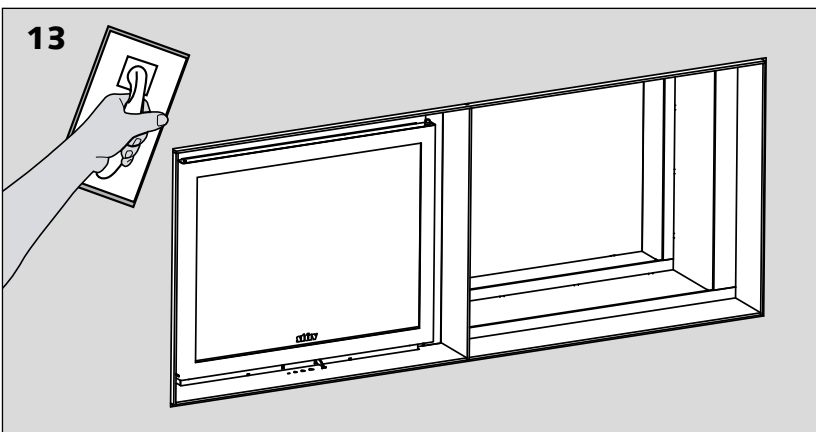

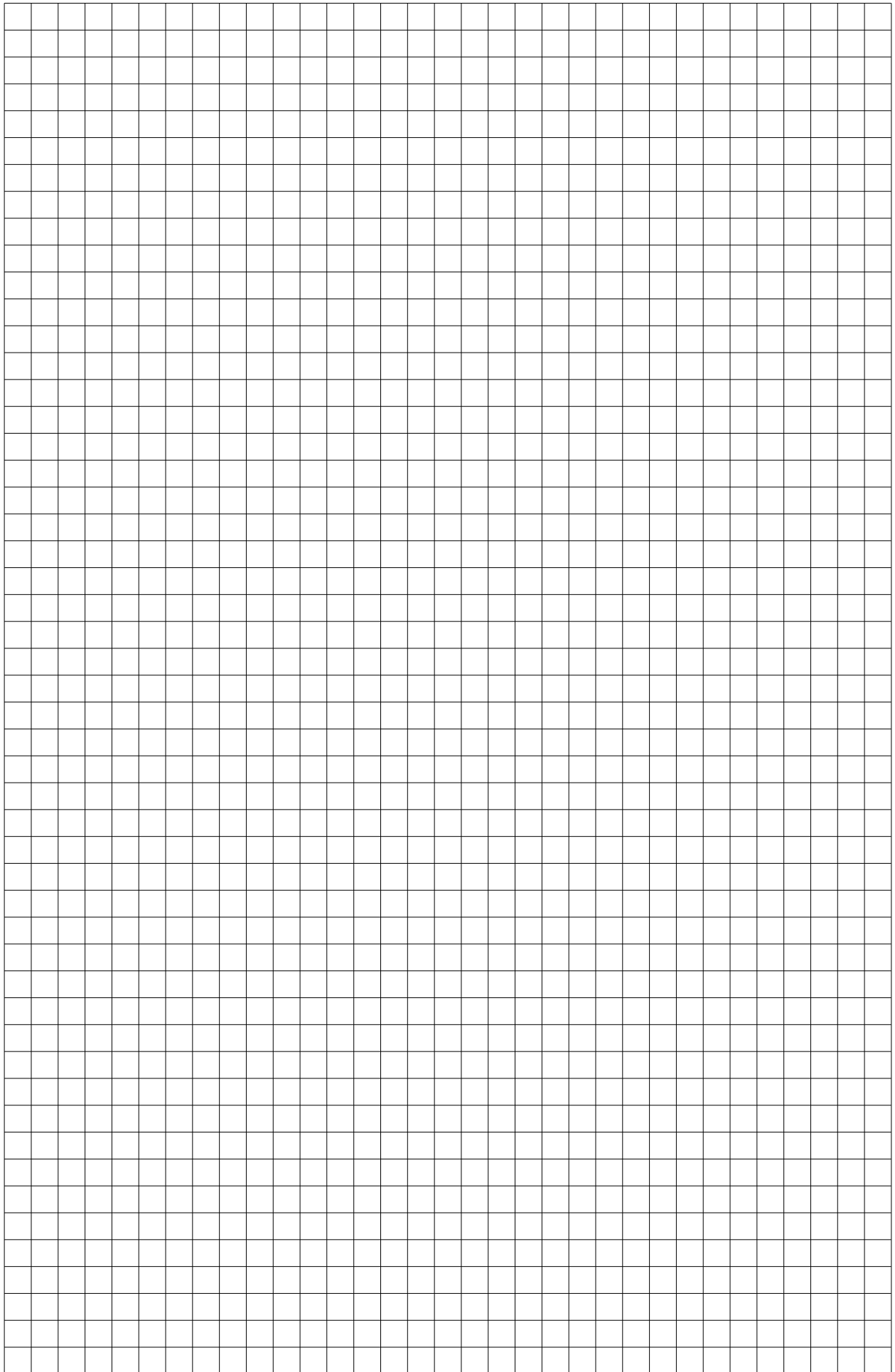

MAINTENANCE

Please note

Wait for the stove to cool down completely before carrying out maintenance.

Clean with a dry cloth.

To clean Stûv finishing surfaces, use traditional, non-abrasive household detergent.

Stûv cladding with a rust finish must be treated with beeswax at least once a year.

Never use solvents (acetone, white spirit).

Marks left by indelible markers cannot be removed.

If necessary, Stûv can provide a spray canister for touch-up work.

Please contact your dealer about this.

CONTACTS

Stûv stoves are designed and manufactured in Belgium by:

Stûv sa
rue Jules Borbouse 4
B-5170 Bois-de-Villers (Belgium)
info@stuv.com – www.stuv.com

Importer for Finland

Ilkka Alatarvas OY
Pikkujärventie 4B
01680 Vantaa
T 400 872 858
www.takkamaailma.com

Importer for Sweden

Eldoform Sverige AB
Slipgatan 2 – 117 39 Stockholm
T 0707 883 53 – www.eldoform.se

Importer for Denmark

Stove APS
Aldershvilevej 84 – 2880 Bagsvaerd
T 51 33 10 93

Importer for Estonia

Tulering Kaminasalong OÜ
Sopruse 145 – 13417 Tallinn
T +372 56 249 004 - www.tulering.ee

installation instructions

D4 frame for Stûv 16-in

[en]

printed on 100% recycled paper

Stûv reserves the right to make changes without prior notice.
These instructions have been produced with the greatest of care. However, we do not
accept responsibility for any errors that may have been made.
Editor: Gérard Pitance – rue Jules Borbouse 4 – 5170 Bois-de-Villers – Belgium

[nl] [de] [it] [es] [pt] [cz] [en] [fr] >
This document is available in several languages:
Contact your distributor or visit www.stuv.com
