

Directions for use

To give to the user

EN

This guide is available in digital format at:

www.stuv.com

Find us also on:

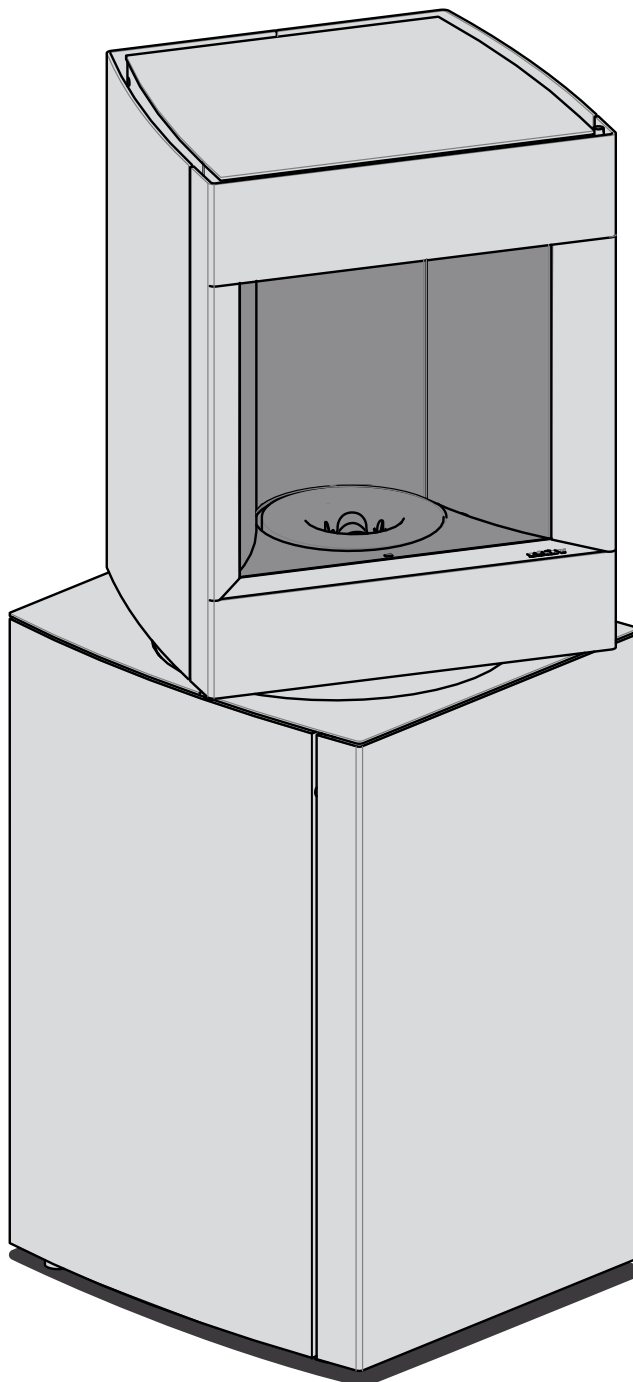

stuv *P-10*

May 2019
186203 > ...
APF 29

WELCOME TO THE WORLD OF STÛV!

You have just opted for an eco-friendly, high-performance heating system.

We hope that you enjoy using it from this moment on.

You will find advice and instructions for the use and maintenance of your Stûv in this document.

CONTENTS

PRESENTATION OF THE PRODUCT	4
Standards, certification and technical characteristics	4
Stûv P-10 CE marking	5
Materials and main components	5
Dimensions	6
Overview of the stove components	7
How does your Stûv P10 work?	8
Fuel	9
USE	10
General recommendations	10
Environment	10
Recommendations before first use	11
Initial cautions	11
Basic usage	12
Managing the remote control	13
Description of the remote control menu	15
Lighting the Stûv P-10	19
2 usage modes: manual mode vs. calendar mode	19
Output mode or thermostat control	20
Using calendar mode	21
Configuring calendar mode	22
Shutting down the Stûv P-10	24
Some advice on getting the most out of your Stûv P-10	24
MAINTENANCE	25
Daily maintenance	25
Weekly maintenance	26
Annual maintenance	29
IN CASE OF PROBLEMS...	31
Emergency switch	31
Alarm signals	31
PRODUCT DATASHEET (EU 2015/1186)	36
DECLARATION OF PERFORMANCE (EU 305-2011)	37
THE EXTENSION OF THE STÛV GUARANTEE: A SIMPLE PROCEDURE FOR MORE PEACE OF MIND.	40
CONTACTS	43

PRESENTATION OF THE PRODUCT

Standards, certification and technical characteristics

The Stûv P-10 stove (for intermittent operation) comply with the requirements of EN European Standards in terms of efficiency, gas emissions, safety etc....

Data provided in this notice are supplied by a certified laboratory.

Results of tests according to EN 14785 standards: 2006
Domestic wood pellet convection heating appliances

Stûv P-10s are covered by:

patent nos.:

EP 2304319

JP 5390603

US 8.904.944

US 8.826.899

+ Patents pending

model drawing nos.:

DM/72417

DM/72418

002500942-0001

002500942-0002



Stûv P-10

System mass	175 kg
Nominal heat power:	8 Kw
Heat output at reduced speed	2.4 Kw
Minimum diameter of the duct for the intake of outside combustion air (if the stove is not connected to outside air)	30 cm ²
Efficiency at rated power	90.5 %
Performance at reduced power	94.5 %
Average smoke temperature at rated power, at the output of the appliance	217 °C
Average smoke temperature at reduced power, at the output of the appliance	94 °C
Minimum safety distance from adjacent combustible materials: <i>(The side and rear distances are measured in relation to the lower part of the device)</i>	<div> <div> <div>> behind</div> <div>7 cm</div> </div> <div> <div>> on the sides</div> <div>10 cm</div> </div> <div> <div>> below</div> <div>non-combustible floor</div> </div> <div> <div>> above</div> <div>10 cm</div> </div> </div>
CO emissions at rated power	0.001 %
CO emission at reduced power	0.028 %
Particle emissions (at rated power)	5 mg/Nm ³
Weight-flow ratio of smokes (at rated power)	5.1 g/s
Mass flow of smoke at reduced power	2.8 g/s
Recommended draught at maximum power	6 Pa
Recommended draught at minimum power	3 Pa
Minimum draught at the output of the appliance for flue calculation.	0 Pa

Standards, certification and technical specifications (continued)

Requirements relating to the electrical power supply

Voltage	230 V
Frequency	50 Hz
Electric power consumption on ignition	1000 W
Electrical power consumption under normal operation	40 W

Requirements relating to fuel

Recommended fuel	Wood pellets only
Certification	Din plus, EN plus A1, NF high performance
Diameter	6 mm
Min-max length	3-30 mm
Humidity level	< 10%
Ash level	< 7%

Stûv P-10 CE marking

	Heating output	Pnom	8.0kW	nominal
		Ppart	2.4kW	reduced
Stûv S.A Rue Jules Borbouse 4, 5170 Bois-de-Villers 15 Notified Body 1881 Declaration of performance number : 15QA151478501	Measured CO (at 13% oxygen content)	COnom	0.001%	nominal
		COpart	0.028%	reduced
EN 14785 : 2006 Stûv P-10 Read and follow operating instructions	Average temperature of the smoke at the appliance's outlet	Tnom	217°	nominal
		Tpart	94°	reduced
Version française disponible dans la notice d'utilisation Nederlandse versie beschikbaar in de gebruikersgids Deutsche Version in der Installationsanleitung La versione italiana è disponibile all'interno della guida utente Versión española disponible en el manual del usuario Versão portuguesa disponível no Manual do Utilizador Česká verze je k dispozici v uživatelské příručce Wersja polska dostępna w instrukcji obsługi	Minimum clearance distance from combustible materials	dr	70mm	rear
		ds	100mm	sides
Use only recommended fuel : Wood pellets diameter 6 mm, quality standard EN plus A1		df	1000mm	front
		Turntable appliance : 1000 mm in range of inspection window		
Appliance efficiency		ηnom	90.5%	nominal
		ηpart	94.5%	reduced
Rated input power			1000W	peak
			40W	average
Rated voltage			230V	
Rated frequency			50Hz	

Materials and main components

The Stûv P-10 consists mainly of:

- > Painted steel sheets/tubes for structural and facing elements
- > The bottom facings are available in a oak-veneered wood panel finish (light or dark)
- > Vermiculite for the inside of the combustion chamber
- > Cast steel for the structural elements of the burner
- > Aluminium for the smoke extraction flue
- > HDPE for the Pellet hopper

> A trim finishing kit is available to trim the bottom facings. In this case, the installer should check that the trim material chosen corresponds to the use for which it is intended.

All of these components are deemed to be compliant within tolerances and national practices.

Stûv has a determinedly proactive responsible environmental approach. We think about the end-of-life of our products.

Each of the device's components can be isolated so that sorting can be carried out and therefore optimum recycling.

Removal of the various parts must be done in accordance with local and national regulations.

Dimensions

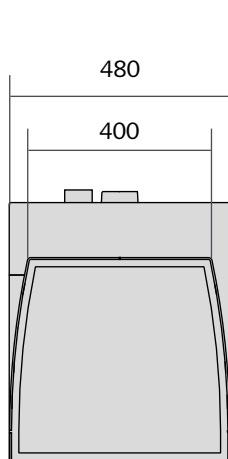

wood and "to be trimmed" version

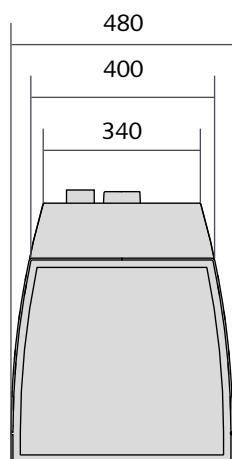

sheet metal version

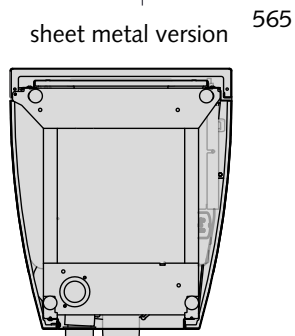
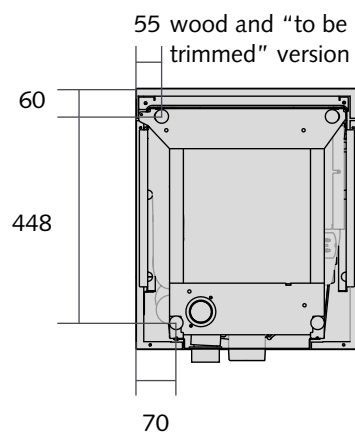
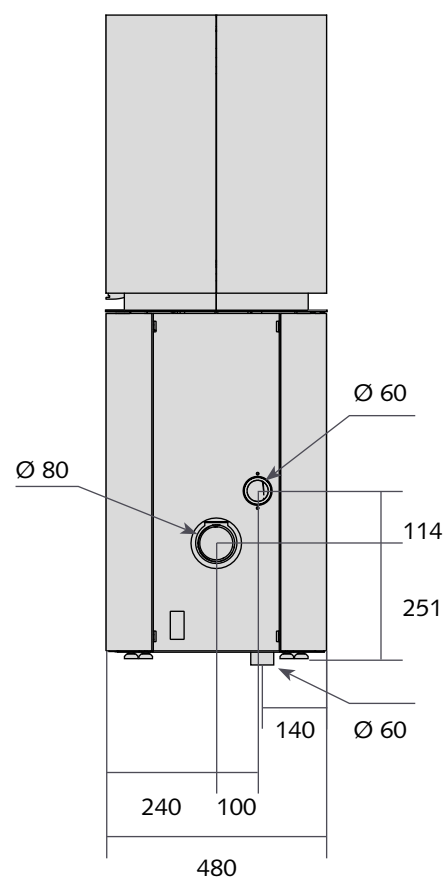
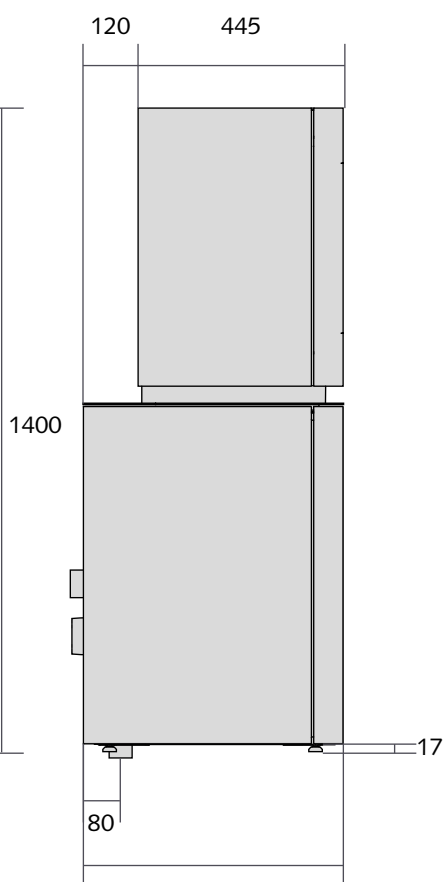
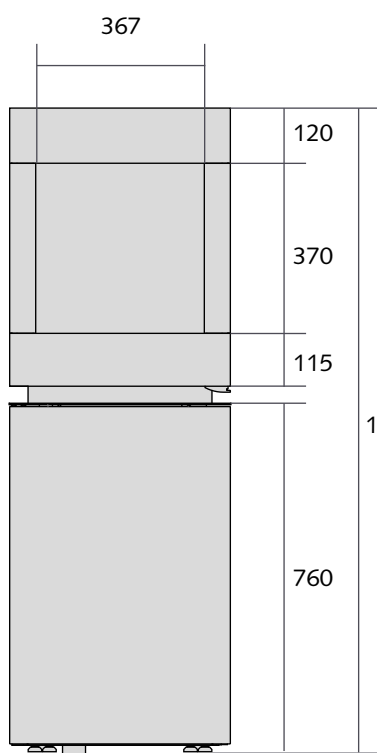

Overview of the stove components

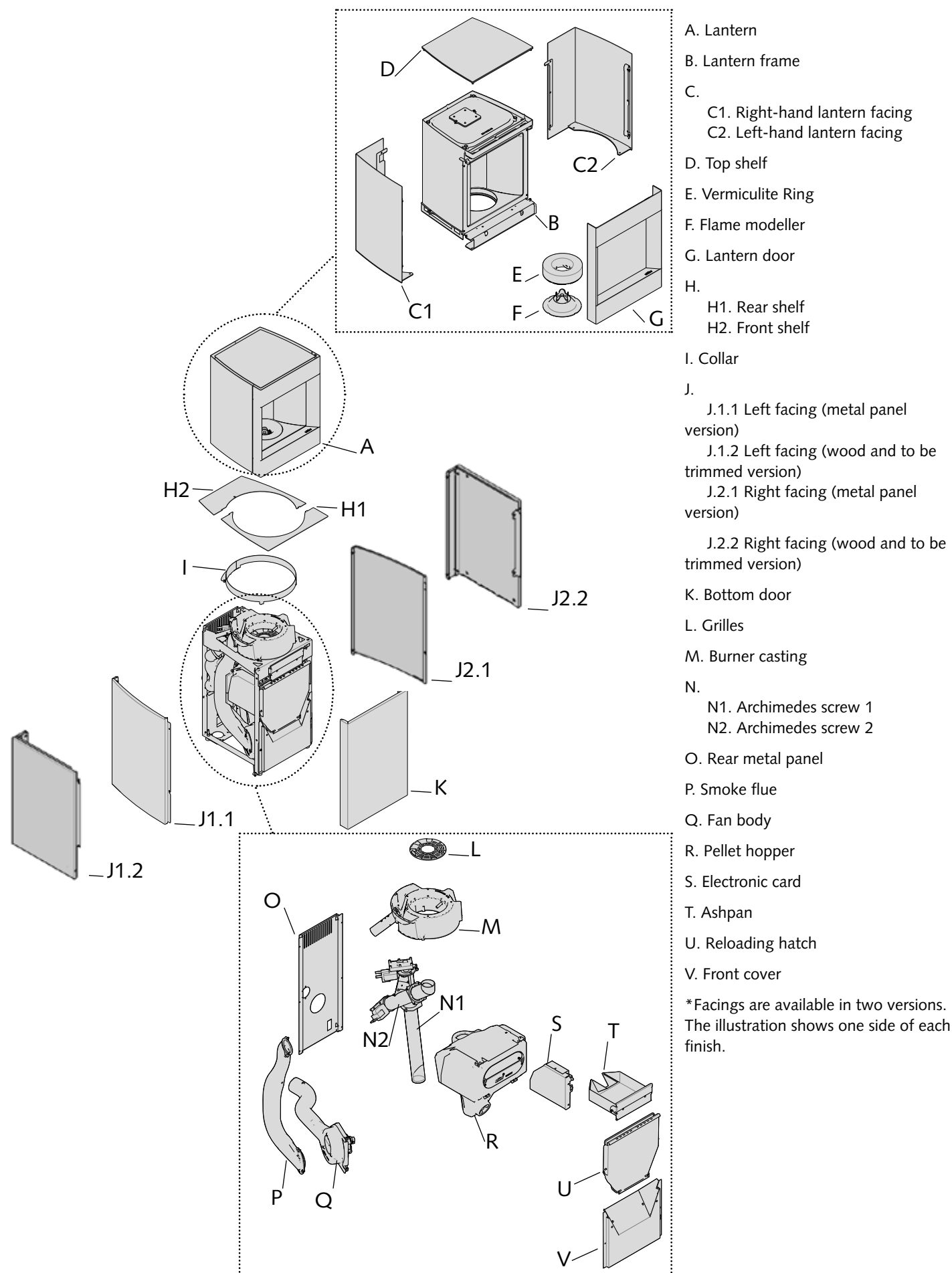

How does your Stûv P10 work?

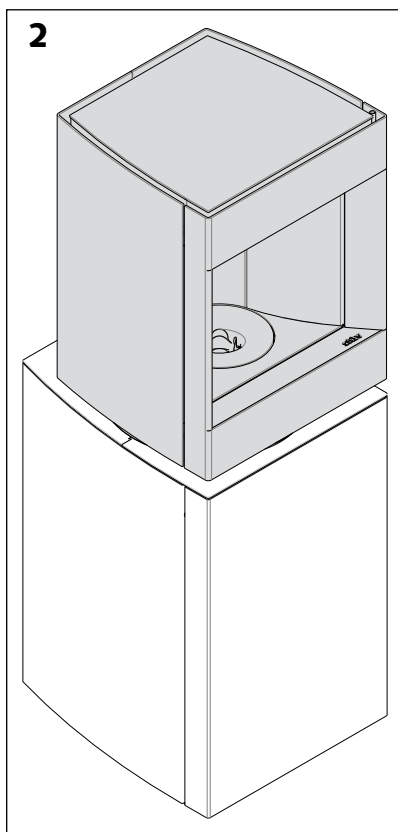
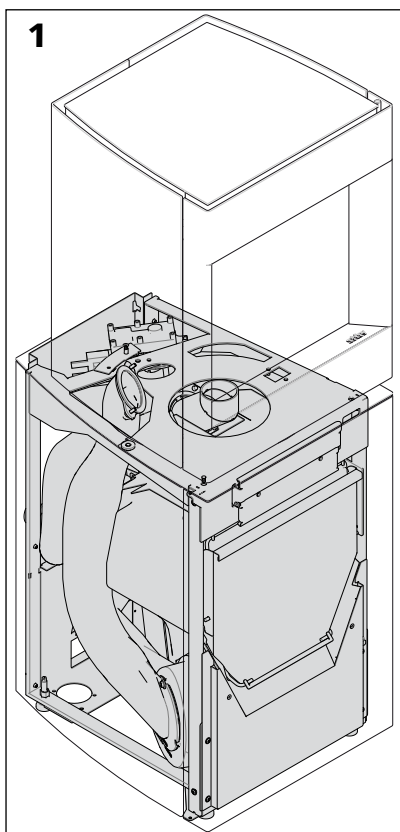

The Stûv P-10 is a wood pellet stove consisting of two major parts:

- A base containing the pellet hopper, the fuel and combustion feed, smoke extraction and all the electronics and sensors enabling the operation of the appliance to be adjusted and set [diagram 1].

- A pivoting lantern where the burning of the pellets takes place. This top part also radiates and diffuses convection heat; it is fitted with a window which gives a view of a beautiful large flame [diagram 2].

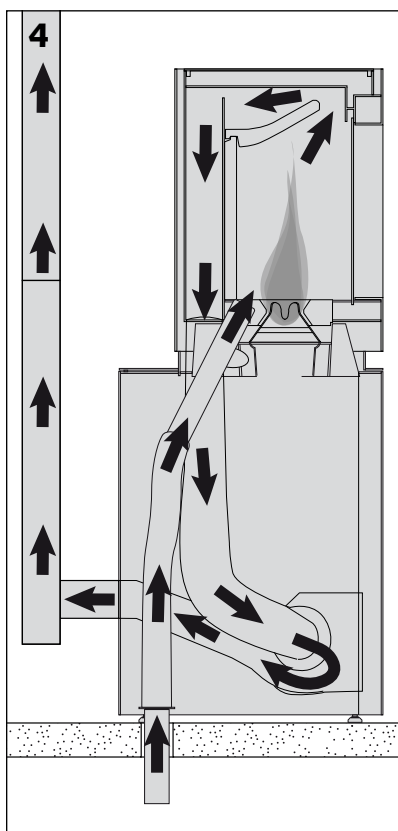
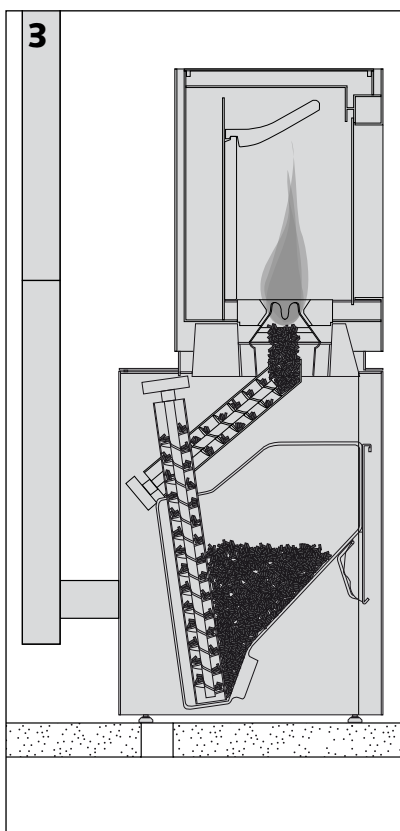

The device has an electronic management system operating on two variables to provide optimal thermal comfort. Depending on the user's requirements, the Stûv P-10 will adjust its output and maintain this by adjusting:

- The quantity of pellets burned [diagram 3]

- The quantity of air supplied to combustion [diagram 4]



What are wood pellets?

Wood pellets are a solid and eco-friendly fuel made from sawmill waste. Sawdust is compressed without glue or binder so as to obtain a standardised cylinder with a high density and low moisture. These characteristics give the granules significant calorific power.

Which pellet should I choose?

The Stûv P10's performance may vary depending on the pellets used. For correct use, the pellets must comply with ENplus or DINplus A1 or NF high performance certifications. These references ensure that the pellets have the following features:

- composition: 80-100% resinous wood
- diameter: 6 mm
- Min-max length: 3 - 40 mm
- humidity level: ≤ 10%
- ash level: ≤ 7%

Burning any liquid or solid other than pellets that comply with the ENplus/DINplusA1/NF high performance standard is prohibited!

The consequences of burning inappropriate pellets

Burning pellets that do not fulfil the above-mentioned criteria can result in device malfunctions such as:

- damage to the glass and smoke ducts
- noise
- burner getting clogged up
- build up of dust in the hopper
- etc.

If you notice one or more of these when using your device, we recommend changing the pellets you are using.

Pellet storage

Pellets must be stored in a dry place where the temperature is

above 5 °C.

They can be stored in bags or in bulk but avoid storage in the open air.

Caution!

Take care not to crush the bags to avoid producing too much dust. Avoid emptying dust into the machine's hopper as this sawdust can disrupt the feed system.

If you use pellets stored in a bag, after opening the bag, use the contents within a relatively short time. Otherwise there is a risk of the pellets getting damp.

**Every Stûv P-10 is subjected to a factory check.
There may be traces of combustion or light residues after this test.**

General recommendations

⚠ Important!

In order to best use the qualities of your appliance and avoid any danger, the following instructions must be followed:

- > Install the stove according to industry best practice and local or national regulations. A qualified professional will ensure compatibility of the flue.
- > Read these instructions carefully and keep them.
- > Observe the instructions for maintenance.
- > Never use the appliance with the door open or a broken window.
- > Never use inflammable liquid in or around the appliance when it is operating.
- > Only use pellets of the recommended quality (DINplus or ENplus A1).
- > Avoid any accumulation of unburned pellets in the burner.
- > Never load the fuel elsewhere than in the hopper.
- > Dispose of ash before each use and empty the ashpan regularly (p.14).
- > Please return the warranty registration card (found at the end of this document), duly completed.

Use

The stove should be used in accordance with local and national regulations and European standards.

Some parts of the stove – the glass door and the outside walls – may become very hot even during normal usage (rated power) and significant heat may be radiated from the glass door.

In order to prevent any damage or risk of fire, when the stove is in use, remove all heat-sensitive objects from the radiation area. Take particular care when you leave the room.

Ensure that the glazed part is not facing any materials that are heat-sensitive.

Do not leave young children without supervision in the room where the stove is installed.

Ensure the air inlets and outlets are always kept clear.

Caution!

The appliance is not designed to be used with cooking utensils. Do not place anything on the appliance or on the facings.

Repairs / Maintenance

Any modification carried out to the system may cause danger and will invalidate your guarantee. Only use Stûv spare parts in the case of repairs.

Should a fire in the flue get out of control

Do not open the stove's door during the initial period.

Disconnect the device.

Call the fire brigade.

If the fire has not died down after a few minutes, use a dry powder, soda acid or sand extinguisher (never water).

After a chimney fire, ventilate the room where the stove is situated.

Have the chimney cleaned and inspected by a professional. Have repairs carried out if necessary.

Environment

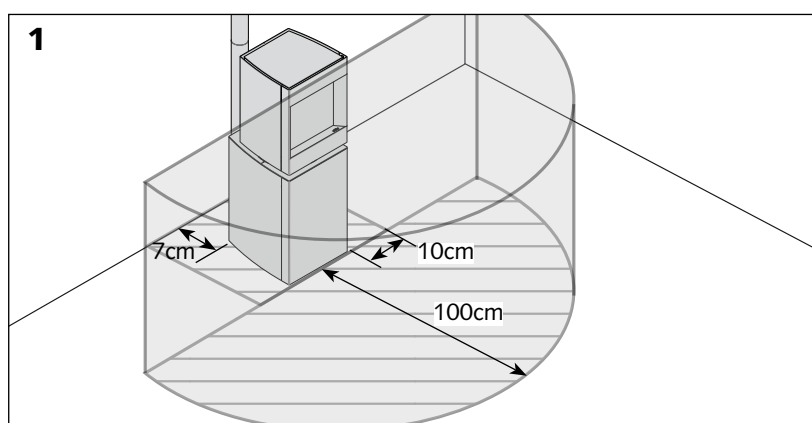

The heat radiated from the glass door and the walls may be significant.

Whichever way the stove is pointing, observe the safety distances with regard to combustible materials [diagram 1], or ensure that the materials exposed to radiated heat are resistant to high temperatures.

The safe distances from combustible materials must be respected, even when the device is switched off as it might have been programmed to switch on automatically or be started remotely.

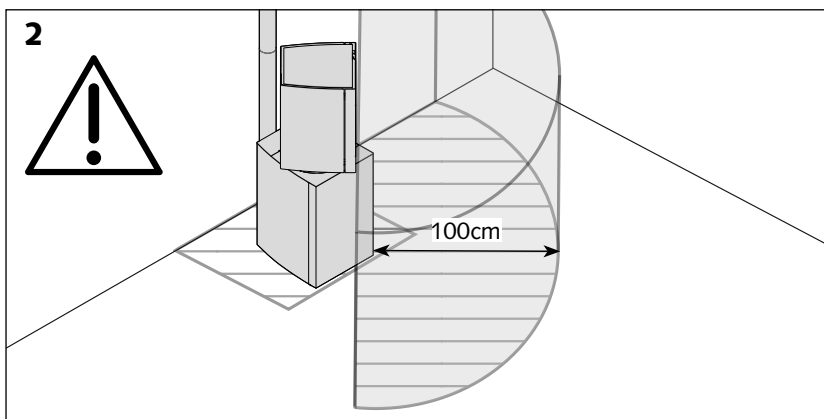

Caution!

Given that the lantern pivots 45° to the left and 45° to the right, the safety distance must follow the direction of the flame [diagram 2].

Warning

Never leave anything on the device's lantern, even when it is switched off!

Recommendations before first use

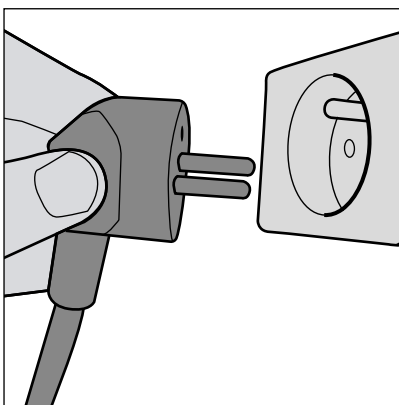

This section relates to the powering up of the appliance. This powering up must be done by an authorised Stuv installer.

The first lighting will help check that each setting is working properly and, if applicable, make fine adjustments to optimise use of the stove depending on the specifics of the installation.

> Connect the power supply to the mains (230V - 50Hz)

> Load the pellet hopper as indicated in the "Basic Procedures" section.

Caution!

As each appliance is tested in the factory, **it is not necessary** to pre-load the Archimedes screw. On the other hand, transport and handling of the Stuv P-10 during installation may have compacted the pellets already in the appliance. Therefore ignore the behaviour of the flame during the first few minutes of operation (it might in particular be more intense than normal).

> Turn on the appliance by following the steps outlined in the "Lighting the Stuv P-10"

Note:

If for various reasons the Archimedes screws have been emptied, it is necessary to perform a preload. Perform the following operations:

> Press and hold

> Choose the "Preload" menu

- Choose "Auto" mode for complete and automatic loading of the screw which lasts 10 minutes.

To cancel, press

- Choose "Normal" mode for manual pre-loading. Press and hold the button to turn the screws.

> Exit the menu

Initial cautions

Before lighting the first fire in the new stove, ensure that no element (piece of hardware, tool, etc.) has fallen into the hopper or remains in the combustion chamber.

The paint is not oven-baked; it is thus relatively fragile but will harden when heated for the first few times. Consequently, take care when handling the appliance.

When lighting the fire for the first few times, some smoke or unpleasant odours may be released from the paint, the steel's protective oil or the drying of the bricks. We recommend that you keep your first fire burning strongly for several hours with the windows open. The paint will harden and the odours will disappear.

The paint of some components inside the combustion chamber will be covered with a protective layer of carbon resulting from combustion.

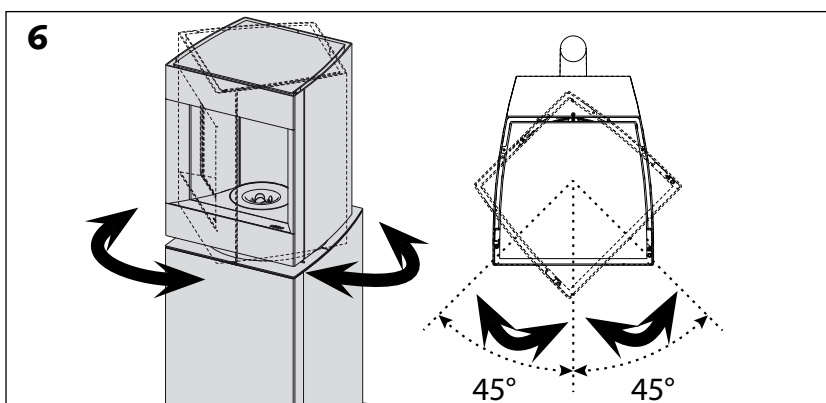
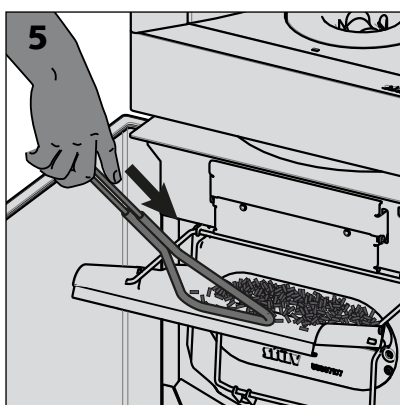
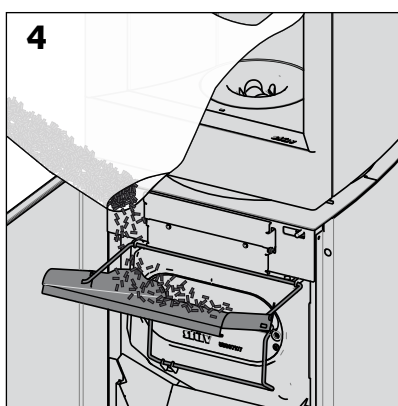
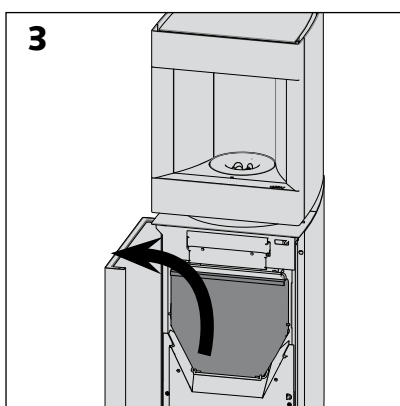
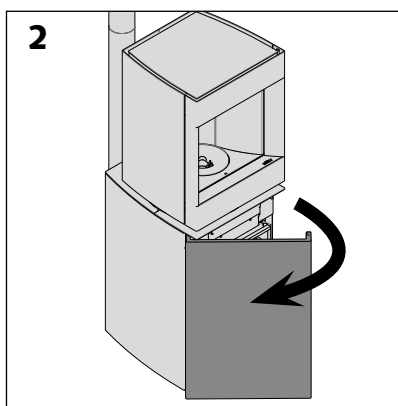
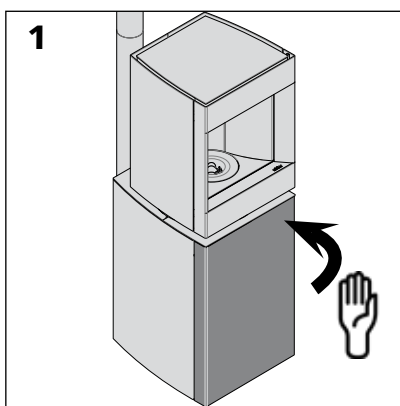

Refuelling with pellets.

It is advisable to refuel the hopper with pellets when the appliance is not lit.

Caution!

If you refuel with pellets while the unit is operating, please do not leave the door open longer than one minute, as beyond this the appliance might display an alarm or even lock down into "safe" mode.

Reminder: it is important to use a quality pellet (complying with DINplus, ENplus A1 or NFhp certifications) and to only pour pellets into the hopper. Avoid pouring in sawdust and dust from the bottom of the bag, as well as any other object. Use the pusher to load more pellets in the hopper and get rid of dust from the valve. Do not use your hands as a watch, bracelet or ring could damage the seal.

The Stuv P-10 is fitted with a sensor that detects the pellet level. If the sensor detects a low level, the unit will reduce its power. If the pellet level rises, the power will go up. If the level continues to drop, the stove will go into "Shutdown" mode. The ideal is to wait until the sensor emits a sound to fill the tank with a 15kg bag.

After refilling with pellets, close the loading valve, making sure no pellets are stuck in the seal.

Rotating the lantern

Use the cool handle to turn the device lantern round 90° [diagrams 7-10].

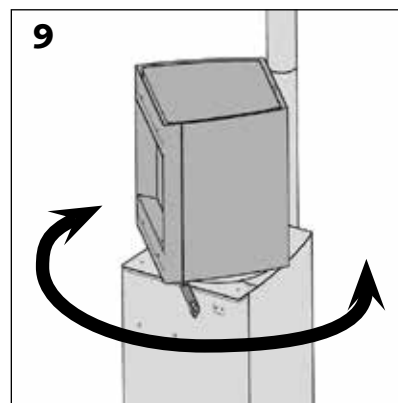
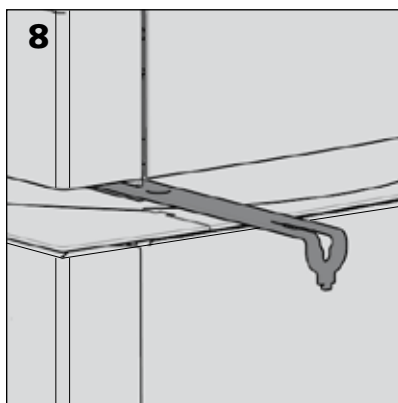
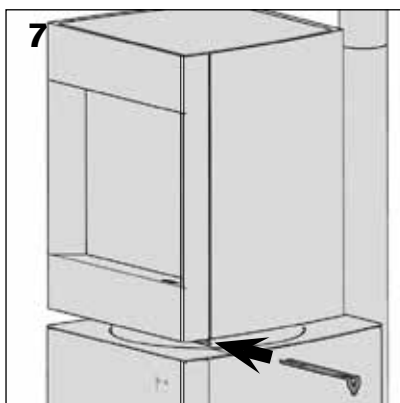

Managing the remote control

The Stuv P10 remote control has 6 buttons and 1 display screen:

0. Display screen

- A. Battery level
- B. Date and time
- C. Signal quality
- D. Basic information (ambient temperature, recommended temperature, power level)
- E. Operating mode
- F. Stove status indicator (see page 23)

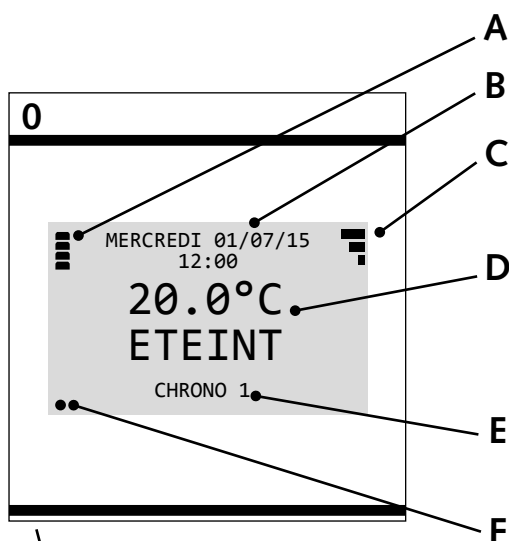

1. Programming the timetable

This function allows you to set the start, stop, and power levels depending on the day and time as well as adjust the set temperature setting.

2. Power on/off button

3. Help

4. Menu

The Menu button is used either to modify the power level or to get access to the appliance's various settings.

It is also used to go into an option or submenu, confirming the choice highlighted.

5. Increase/Move up

6. Decrease/Move down

N.B.: use the down / up arrows to wake up the remote control.

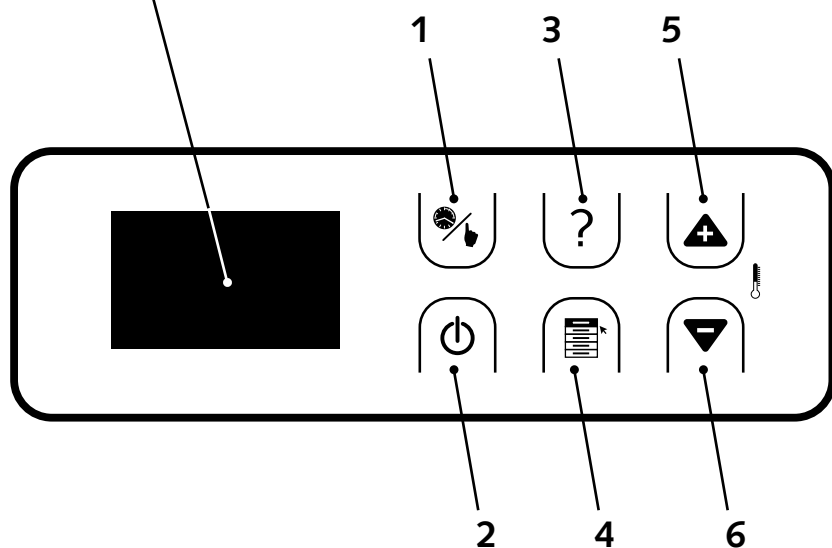

Warning!

Only use rechargeable batteries in the remote control!

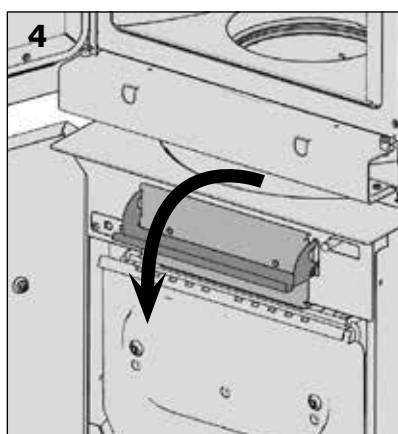
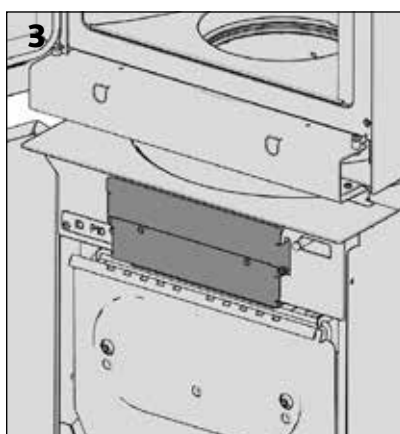
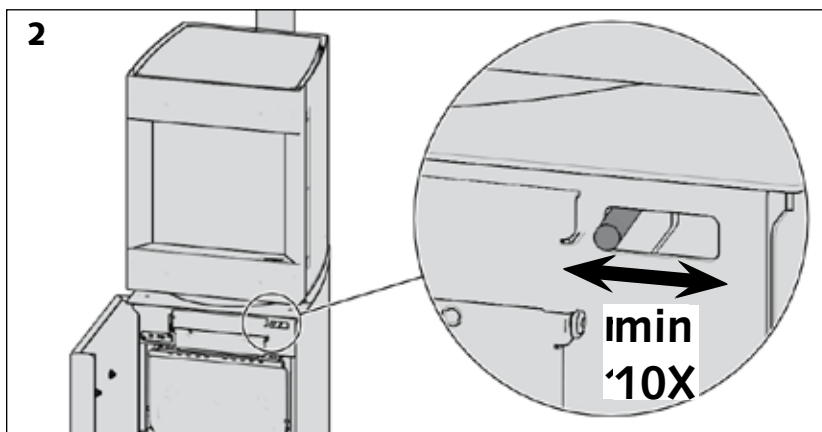
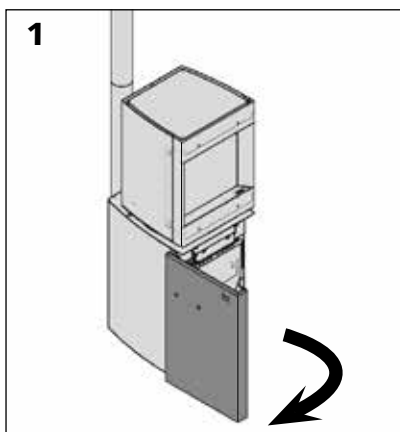

> Before each start, actuate the ash removal control (make ten movements).

> Check that after the operation, the control returns to its original position (rod to the right).

Note:

To check that the grille is turning correctly and goes back to its original position and to check that the ash has been removed and that the grille is clean, you can open the door, remove the vermiculite ring and the flame modeller in order to find the ash disposal grille.

To find out the procedure to follow, see section "Weekly Maintenance", "cleaning the ash removal grille" paragraph

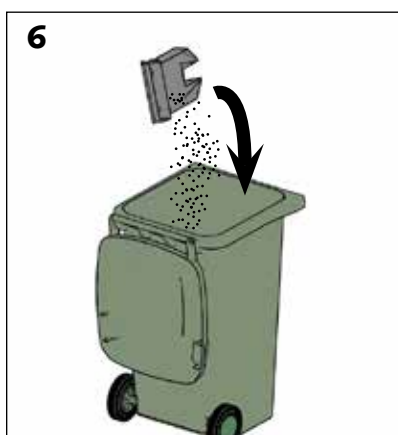
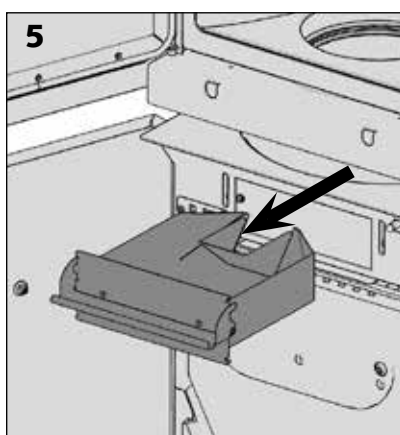

Caution!

Only remove the ash when the appliance is extinguished.

> Empty the ashpan for every 150 Kg of pellets burned.

Caution!

Only remove the ashpan when the stove is off.

Never touch the ashpan when the appliance is operating (risk of burns).

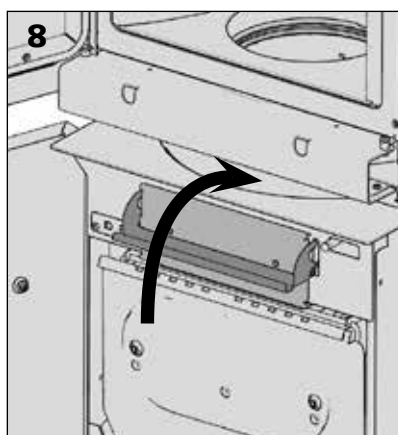
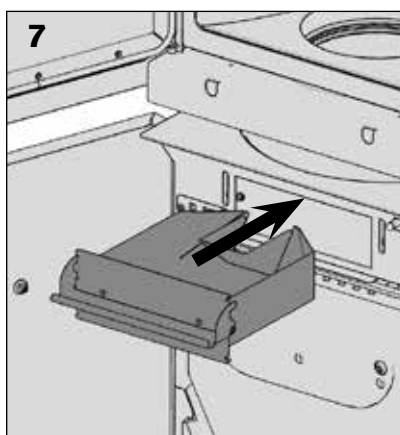

Check carefully that there are no unburned pellets in the ashpan before the appliance is lit.

Description of the remote control menu

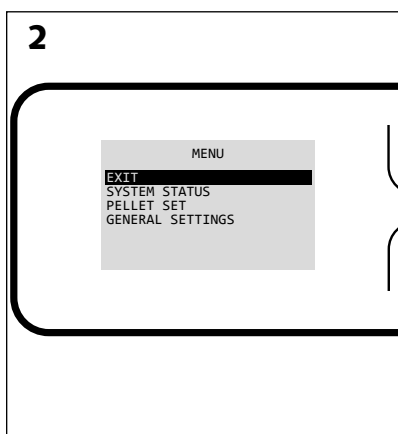
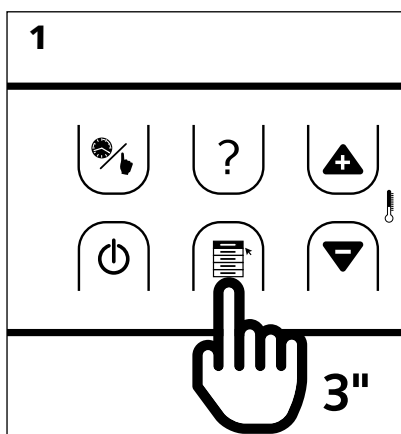

A long press on the Menu button provides access to the list of the same name, including the following submenus:

System status: Contains a set of continually updated information.

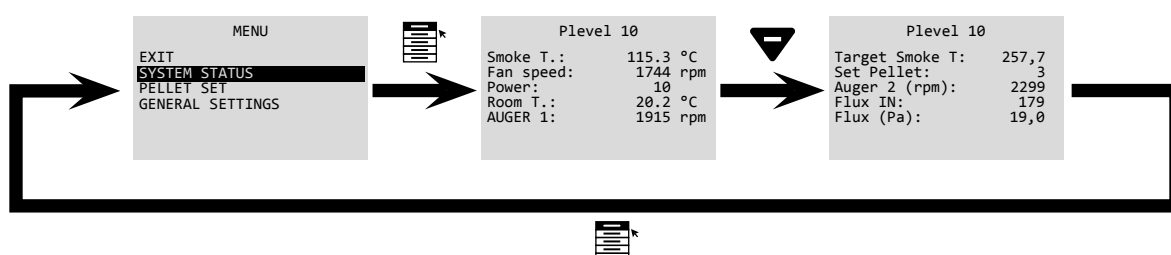

Plevel 10	
Smoke T.:	115.3 °C
Fan speed:	1744 rpm
Power:	10
Room T.:	20.2 °C
AUGER 1:	1915 rpm

- / Smoke temperature
- / Speed of the smoke extractor
- / Current power level
- / Ambient temperature
- / Screw rotation speed 1

Plevel 10	
Target Smoke T:	257,7
Set Pellet:	3
Auger 2 (rpm):	2299
Flux IN:	179
Flux (Pa):	19,0

- / Smoke temperature to be reached according to "Set Pellets"
- / Set pellets
- / Screw rotation speed 2
- / Air flow measurement (no unit)
- / Pressure difference at the flow rate measurement diaphragm

PELLET SET: The flow of pellets in the feed system depends on the characteristics of the pellets (length, density, etc.). It may therefore differ from one brand to another. For example, short pellets have a tendency to rise more rapidly in the Archimedes screws, even if they turn at a constant speed.

To compensate for this difference in flow, it is possible to correct the speed of the Archimedes screws from -15% to +15% compared to the reference value (the speed of the smoke extractor, however, is not changed, the aim being to get a correct air/fuel ratio). This is possible using the SET GRANULES menu

Once it is operating normally (after around 1hr) at power level Pniveau20, the following points may indicate a low pellet flow, in which case you will need to increase the SET GRANULES level:

- Low, bright flame
- White layer on the glass

the following points may indicate a high pellet flow, in which case you will need to decrease the SET GRANULES level:

- Very tall, colourful flame (touching the top of the combustion chamber)
- Blackened glass

Description of the remote control menu (continued)

When the SET GRANULES level is increased above level 3 (increase of the speed of the Archimedes screws), the power level is deliberately restricted: it is therefore normal to no longer be able to reach Plevel20.

> Maximum output as a function of the pellet setting:

Pellet set	Max. Output
0	20
1	20
2	20
3	20
4	19
5	18
6	17

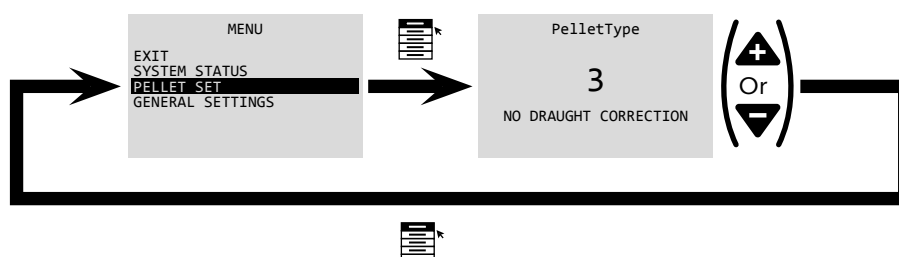

General Settings: The "General Settings" menu consists of the following submenus:

> **Program date/time:** This screen allows you to set the date and the time.

Once in the clock menu, set the desired number using the arrow keys; to move to the next number, press the menu button. Once the date and time are entered correctly, press and hold the menu button to return to the "General Settings" screen.

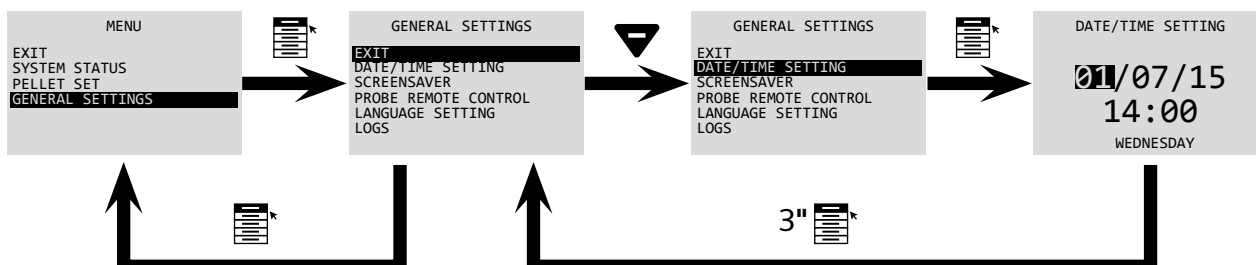

> **Screen Saver:** This option cannot be activated..

> **Remote control thermostat:** Enable/disable the temperature sensor contained in the remote control.

When the remote control thermostat is enabled, the appliance regulates its temperature depending on the data sent by the remote control. Otherwise, the temperature sensor probe is located in the appliance. If you opt for regulation via the remote control sensor, place it in a suitable place: not too sunny, not too close to the lantern, do not leave it in a room other than the one where you installed the Stûv P-10, etc.

N.B.: if the remote control switches itself off (for example, because the batteries have run down) or goes into sleep mode, the stove sensor automatically takes over.

Note: It is normal for there to be a slight different between the temperatures measured by the remote control sensor and the stove sensor.

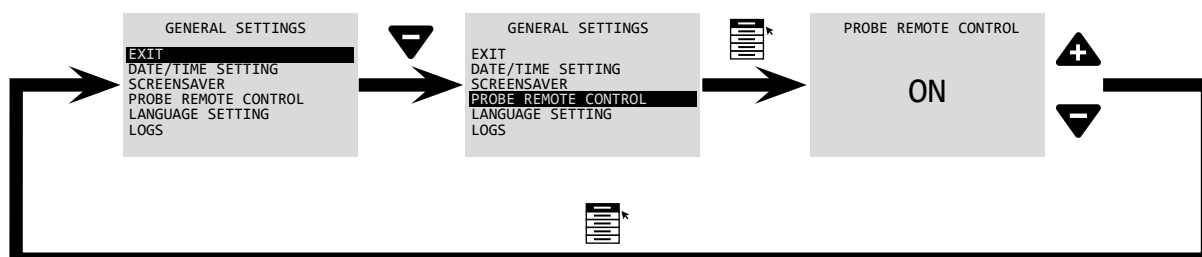

Description of the remote control menu (continued)

> **Program Language:** The “Program Language” screen is used to switch the interface between the different languages available.

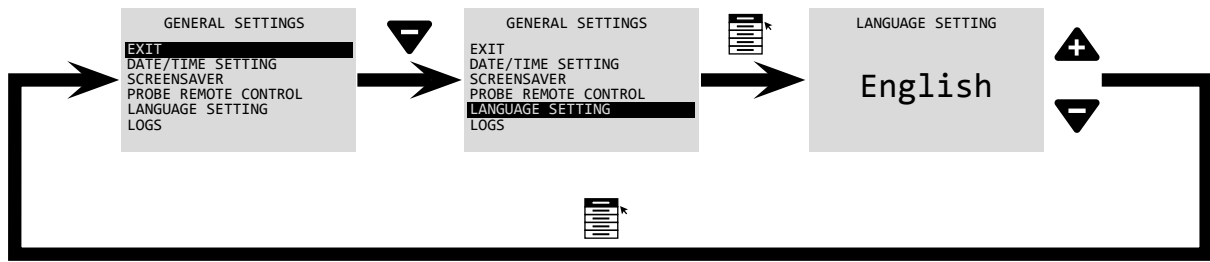

> **Records:** Each incident is logged under this tab. The information stored is: The nature of the incident, the date and time the incident occurred and the phase during which the incident occurred.

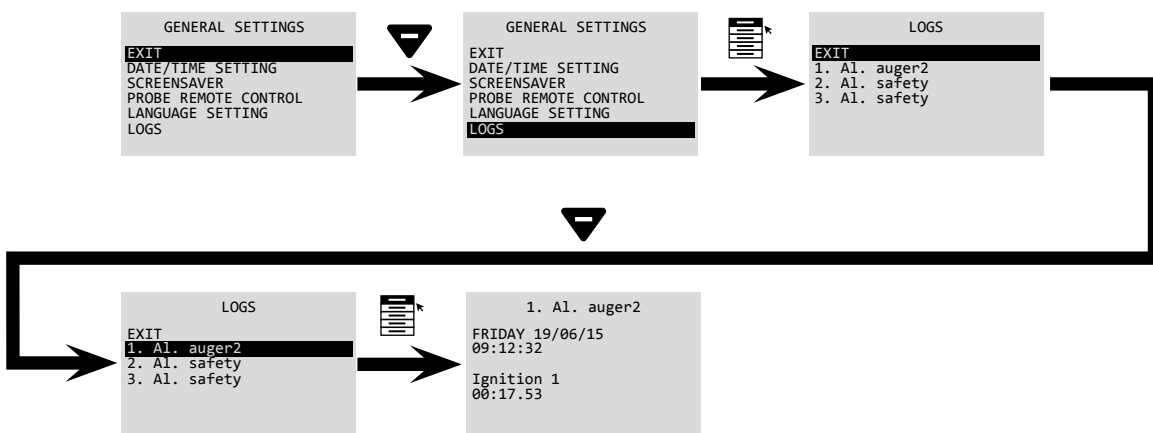

> **Service:** The “Service” screen indicates the number of operating hours and number of starts made.

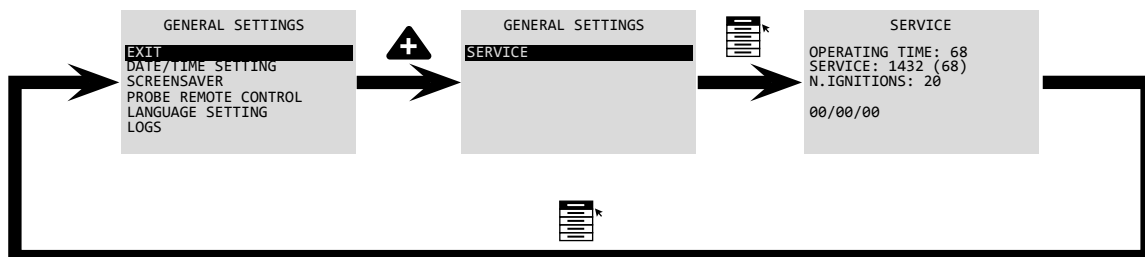

- > **Eco-stop:** The "Eco-stop" screen is only available when the appliance is thermostatically controlled. When the setting is "ON", the appliance turns off when the ambient temperature stays above the set temperature plus one degree for more than 5 minutes. If the ambient temperature drops below the set temperature minus one degree, the appliance will restart automatically.

Caution regarding the time it takes to shut down and restart!

When the setting is "OFF", the appliance will drop to the minimum heat output level once the set-point temperature has been reached, but will not extinguish automatically.

N.B.: even when the Eco-stop function is activated, you must remove the ash from the device every time before you switch it on.

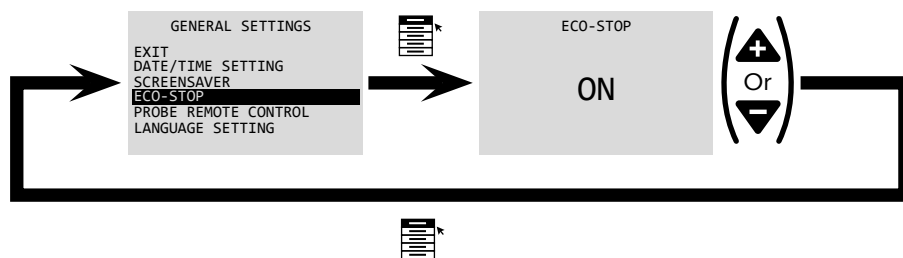

- > **SMART MODE :** the "SMART MODE" screen is only available when the appliance is controlled by the thermostat.

When it is set to "ON", the control anticipates the set-point temperature being reached and reduces the output. This mode prevents the set-point temperature being significantly exceeded.

When it is set to "OFF", the appliance operates at maximum output as long as the ambient temperature is below the set-point temperature. Once the ambient temperature exceeds the set-point temperature, the appliance operates at minimum output.

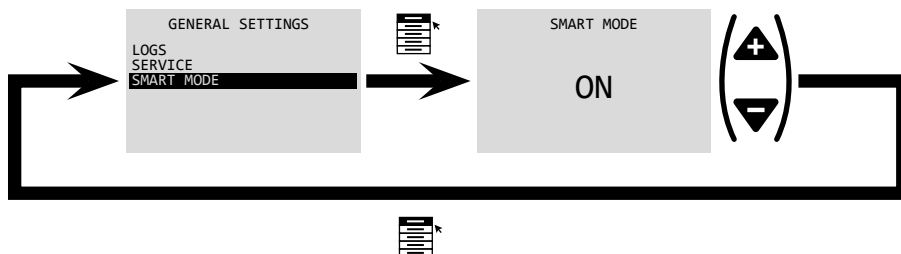

Lighting the Stûv P-10

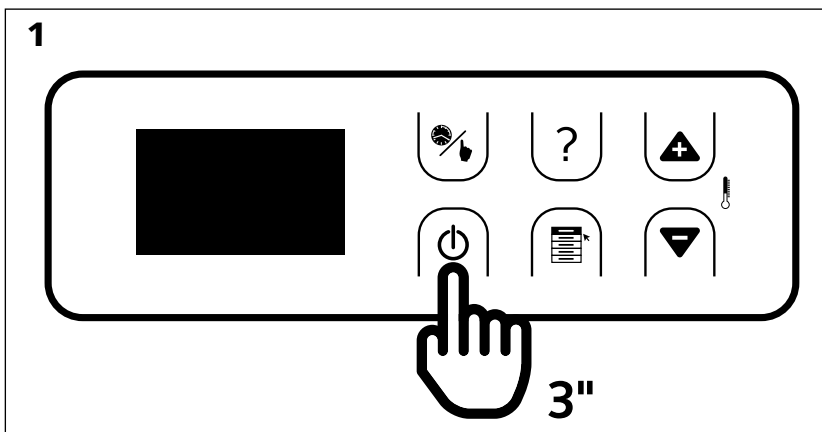

> **Start by removing the ash from the device**

- > To light your Stûv P-10, press and hold the button for 3 seconds
- > The appliance will review its various sensors.
- > The stove then goes on to load the screws.
- > Once there is a sufficient quality of pellets, the ignition phases start. The flame now appears (10 - 12 minutes).

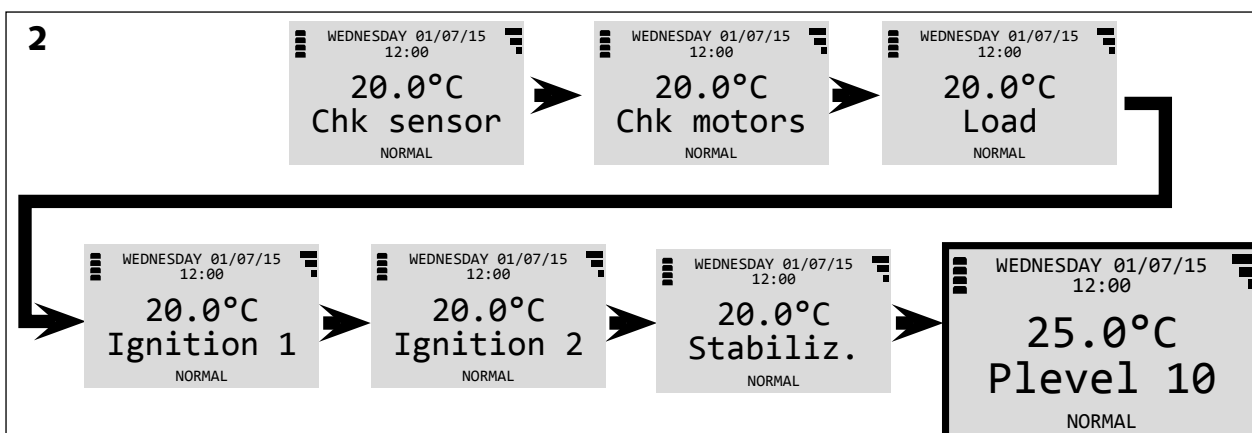

Note!

On lighting, it is possible for the combustion chamber to be filled with smoke. This is normal and is due, for various reasons, to slower burning of the pellets (e.g. slightly damp pellets etc.) Once the flame appears, all the smoke will disappear.

Never disconnect the appliance when lighting it!

Never remove ash from the device while lighting it!

- > The lighting stages are completed as soon as the level is displayed on the screen (20 - 25 minutes).

2 usage modes: manual mode vs. calendar mode

The Stûv P-10 allows two ways to control power. A calendar mode which enables direct power changes, or a calendar mode where temperature management is defined in advance, day by day, half-hour by half-hour (4 possible schedules).

Whether calendar mode is activated or not, it is possible to manage the power of the appliance through power levels or through a temperature to be reached (set temperature).

2 usage modes: manual mode vs. calendar mode (continued)

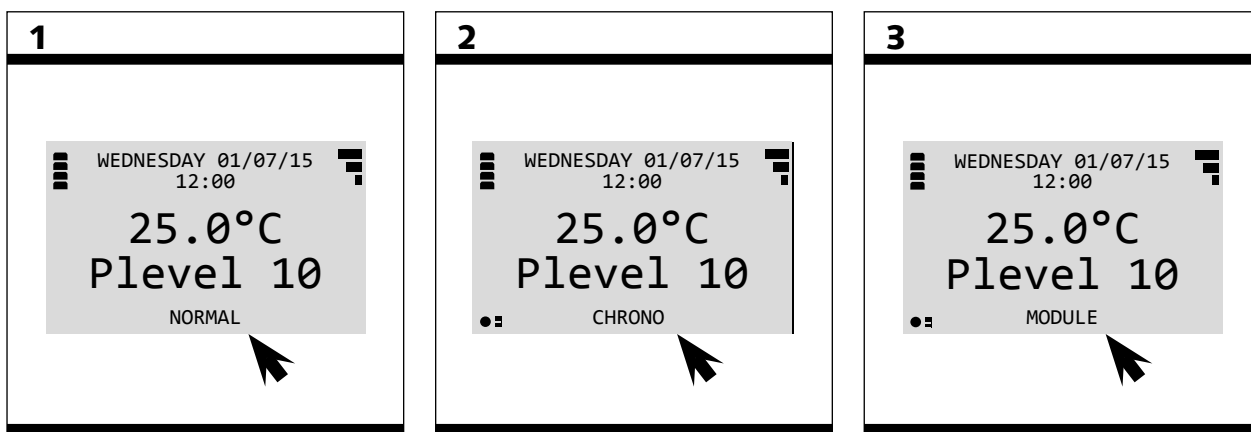

The bottom of the screen may display 4 different pieces of information:

> NORMAL

This information is registered when the calendar is not enabled. The stove is operating in manual mode.

> CHRONO

This information is registered when the calendar is enabled. The term CHRONO is followed by the number 1, 2, 3 or 4. This number

corresponds to the enabled calendar programme.

> MODULE

This word is displayed when the room temperature measured by the stove is greater than the setpoint temperature when thermostatic regulation is enabled (regulation of the appliance according to temperature and not power level).. If calendar mode is not enabled,

only "module" appears on the screen. If calendar mode and thermostatic regulation are enabled, "Chrono" and "module" will be displayed alternately.

Output mode or thermostat control

A short press on the button switches successively between the 3 screens shown below.

An initial short press allows you to enable or disable thermostatic control of the appliance.

If thermostatic control is enabled, the following screen shows the temperature of the room and allows you to specify the required set temperature, that is, the temperature you wish to reach in the room where the thermostat sensor is placed (appliance or remote control). Raise or

lower the set temperature using the arrow keys.

If thermostatic control is disabled, the next screen allows you to raise or lower the power level at which the appliance operates. The range of powers available goes from level 1 (+/- 2.5 Kw) to 20 (+/- 8Kw). To change the power, use the arrow keys on the remote control.

Note: In order to avoid condensation forming in the smoke flue, a restriction is performed at the factory to block access to level 1 to 4. Lifting the restriction can be carried out by your installer after checking flue compatibility.

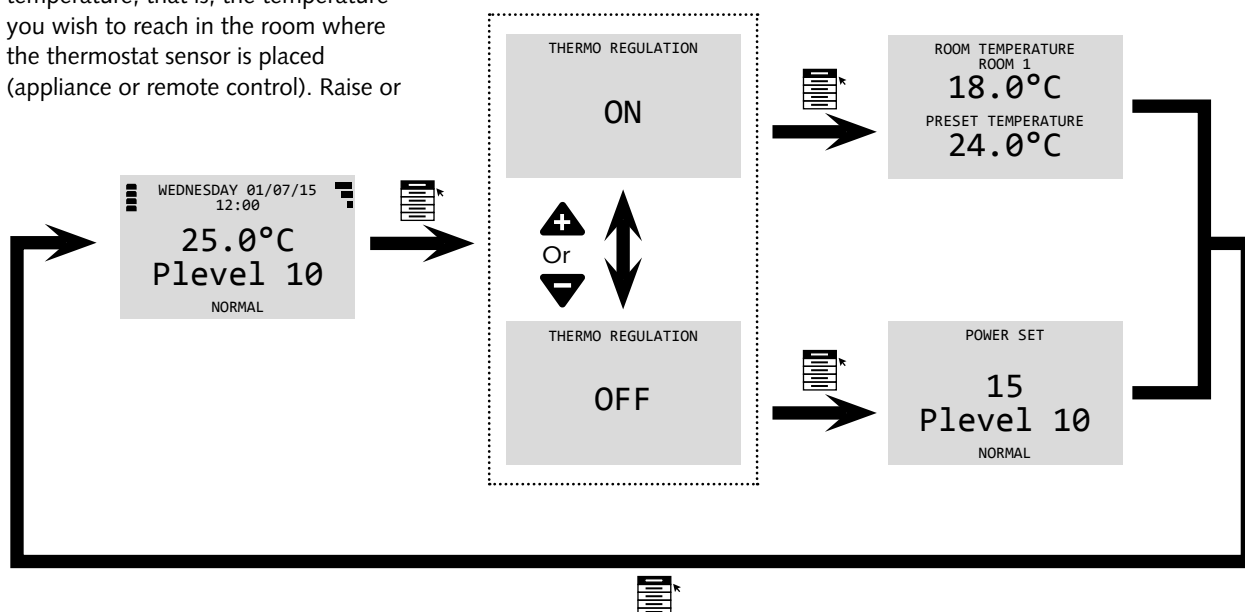

Using calendar mode

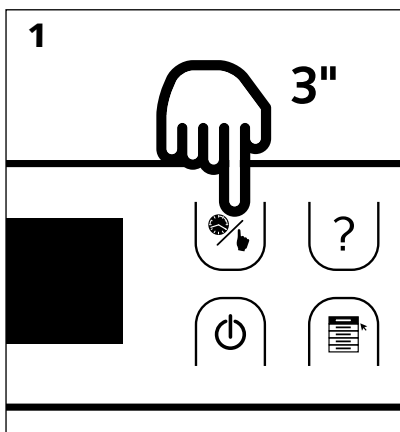

The calendar function allows you to set the automatic starting and stopping of the stove as well as adjusting the power and the set temperature. To access this menu and to enable or disable the calendar, press for more than 3 seconds on the button

The calendar menu consists of the following submenu:

Exit: Exit the calendar menu.

Enable calendar: Enables or disables calendar mode. It is possible to schedule four different programmes. To disable calendar mode, select the "normal" programme.

Comfort menu: Setting the power or the maximum temperature during programming.

Normal menu: Setting the power or the average temperature during programming.

Economy menu: Setting the power or the minimum temperature during programming.

Week programme: Allows different programmes to be created (maximum 4).

Caution!

Settings in the comfort, normal and economy menus are made either at power level or in temperature. To switch from power level to temperature and vice versa, you must:

- > Return to the Home screen

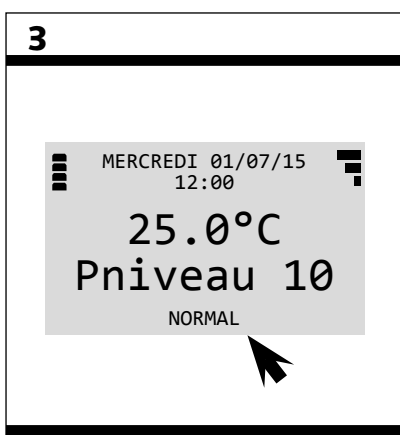
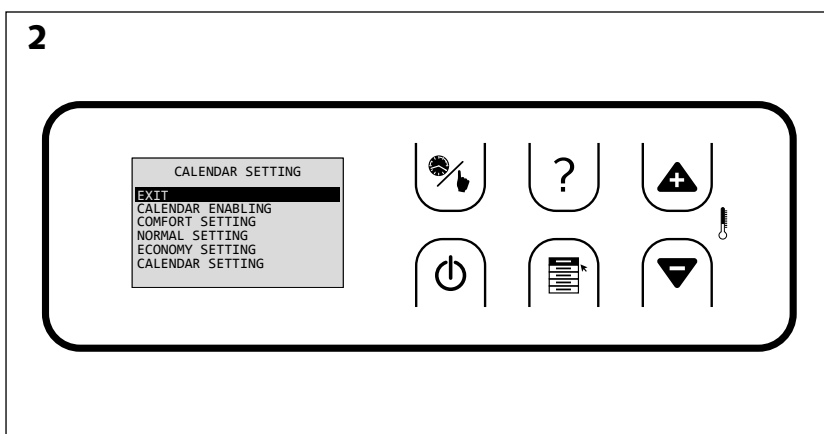

Caution!

If an alarm is triggered on the device, the calendar is automatically disabled in order to protect the system. When the causes of the alarm are resolved, you will need to re-enable the calendar.

Caution!

If you change the operating mode or switch on or switch off the device when the calendar is enabled, the calendar will be disabled. The operating mode displayed on the remote control will then change from "CHRONO" to "NORMAL" [diagram 3].

Caution!

Even when in calendar mode, **removing the ash is essential**. Make sure you can remove ash from the device between each operating period.

- > Press briefly on the button

- > Press the and buttons to enable or disable thermostatic control.

When regulation is enabled, settings are made through the desired temperature in degrees Celsius. Otherwise, the adjustments are made in power levels (between 1 and 20).

1. Define 3 basic temperatures.



Calendar mode varies between 4 states: a state where the appliance is off, 3 states representing three temperature levels, i. e. a lower level, an intermediate level and a higher level. The first step is to define these three values between which the appliance will vary. The choice can be made either in power level or temperature. To do this, enable or disable thermostatic control (see "Calendar mode" section).

> Press the  button for 3 seconds to go into the "Calendar programming" menu.

> Go into the economy, normal and comfort menus successively in order to set the desired temperatures.

The Economy menu defines the lower temperature, the normal menu defines the intermediate temperature and the highest temperature is defined in the comfort menu.

Note:

Once in the "Calendar programming" menu, use the  and  buttons to navigate the menu. Briefly press the  button to enter the economy, normal and comfort menus. Make a long press on this button to return to the "calendar programming" menu.

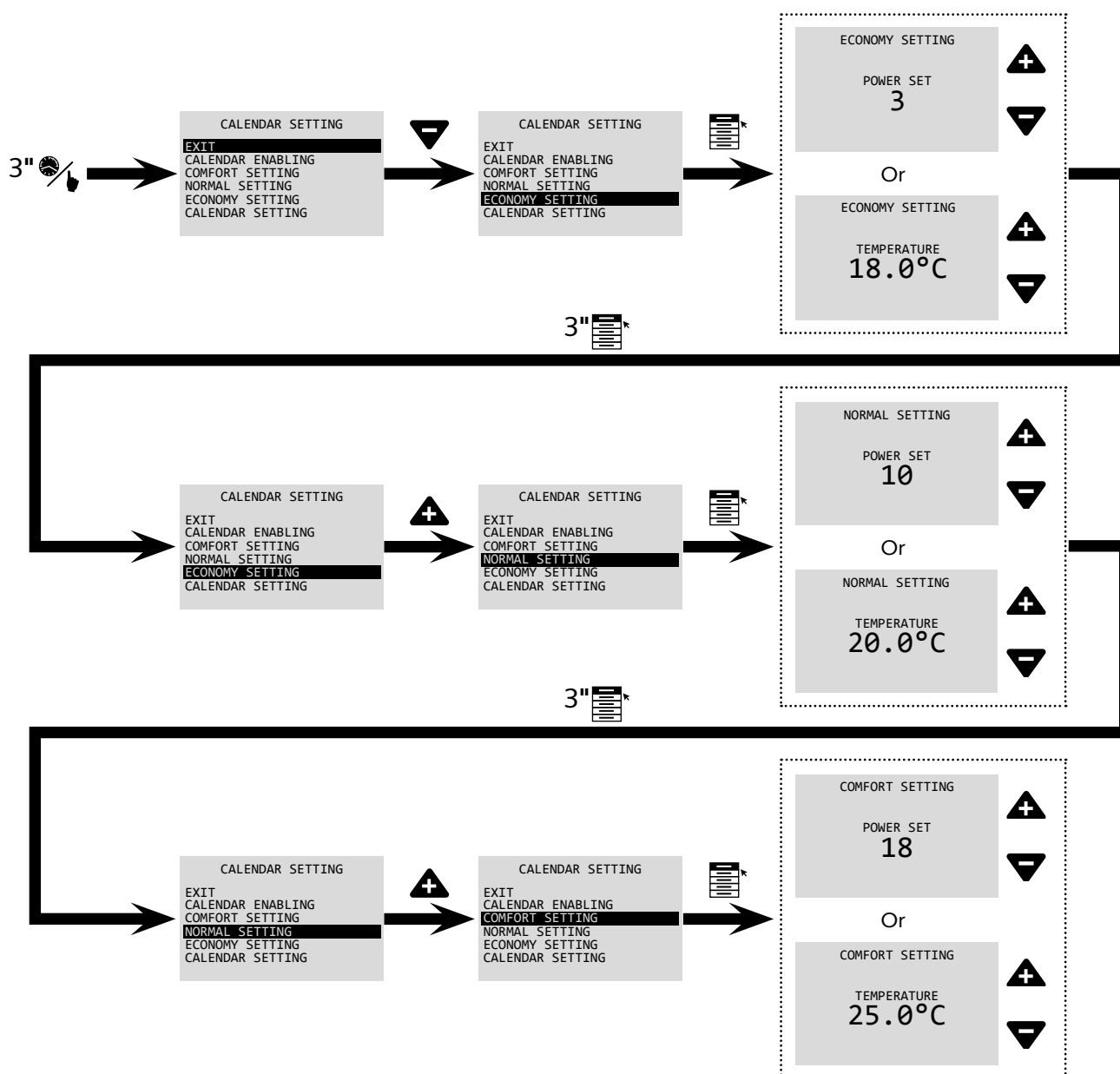

Caution!

When the calendar is activated, the output level or set-point temperature is that defined in the "comfort setting", "normal setting" and "economy setting".

When the calendar is deactivated, the output level or set-point temperature is that set using the  button (see p.19).

2. Perform scheduling.

The scheduling of the various calendars (maximum of 4) is carried out in the "Week programme" menu. This screen shows the following information:

- 24 numbers corresponding to the 24 hours that make up a day.
- Each hour is divided into two half-hours represented by a bar.
The height of the bar indicates the programme applied at that time of day:
a: the appliance is off.
b: the temperature or power level is defined in economy mode.
c: the temperature or the power level is the one defined in normal mode.
d: the temperature or power level is the one defined in comfort mode.
- A figure indicating the programme number as it will be shown in the "enable calendar" menu.
- The name of the day concerned.
Successively create a programme for each day of the week.
- The "Copy" tab gives the opportunity to copy the entire programme for the day displayed to apply it using the Paste tab to a different day.
- The "Paste" tab applies all of the settings previously copied.
- Exit tab.

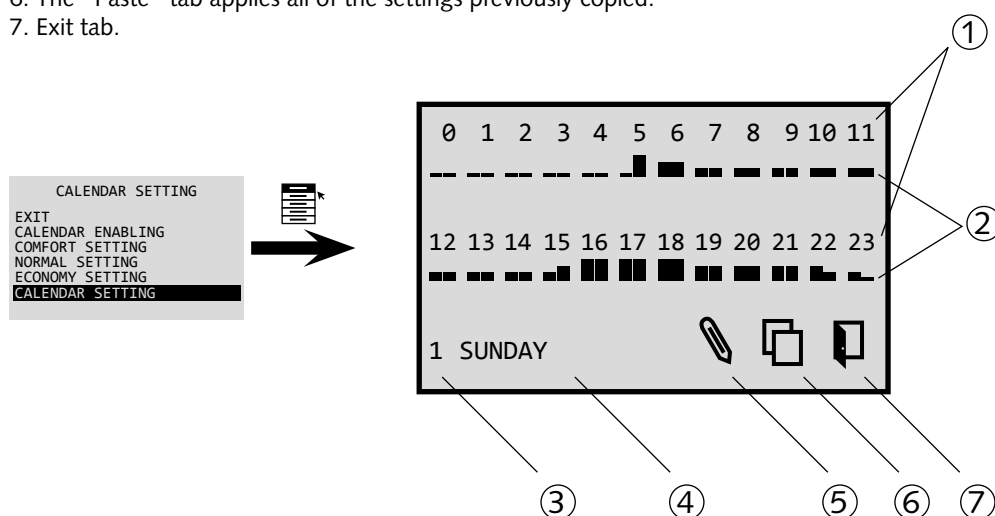
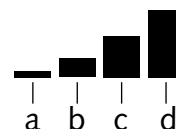

Note:

Once the "Week Programme" screen is displayed, move the cursor keys using the ▲ and ▼ buttons. To change the highlighted item, press .

To exit the "Week programme" menu, highlight icon 7, and press .

3. Enable scheduling.

- > Enter the "Enable calendar" menu
- > Select the desired schedule.
- > To enable it, press .

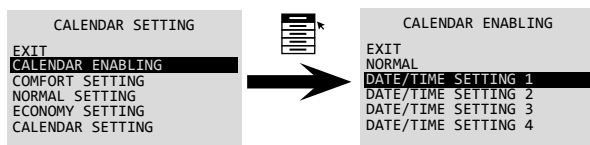

The calendar is then activated and the stove will light/extinguish at the programmed times.





Attention!

In calendar mode, the stove is constantly active. Press the button to completely switch off the device and exit calendar mode.

The black circle in the bottom left-hand corner of the screen indicates that the stove is active.

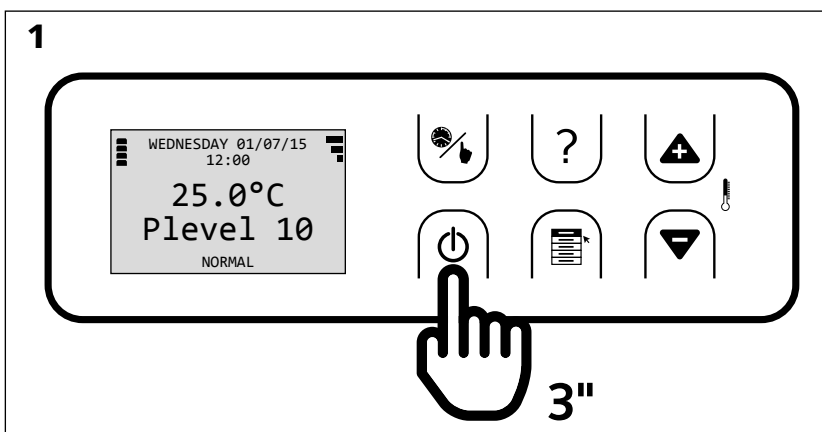
Shutting down the Stûv P-10



> To turn your Stûv P-10 off, press and hold the  button for 3 seconds.

From this time on, the appliance will stop one of the two feed screws and empty the second.

The Stûv P-10 will therefore continue to operate for about 15 minutes at a power equal to P10.

> Never unplug the device to switch it off! (even if an alarm is triggered) (unless there is a chimney fire)

> Never remove ash from the device while it is going out!

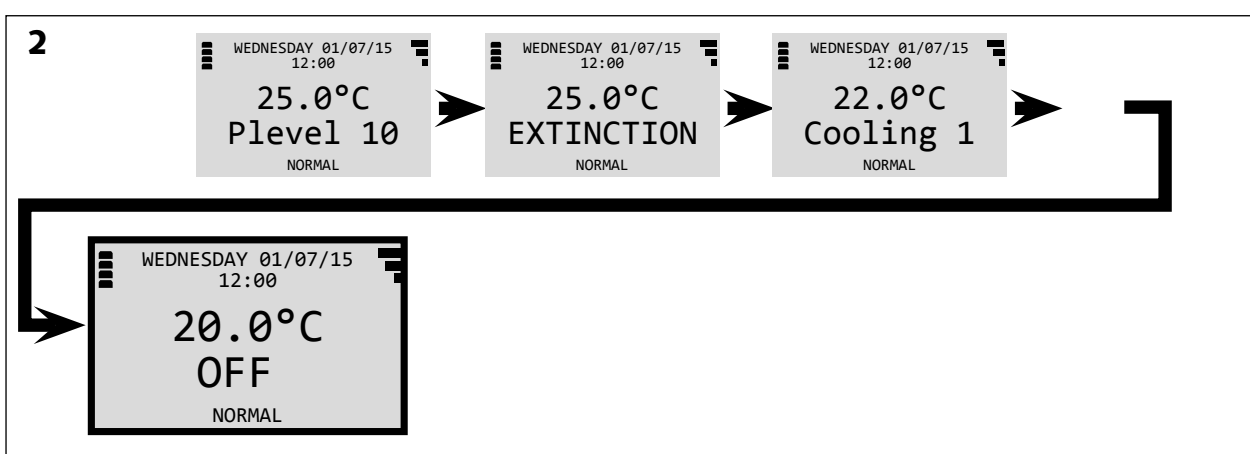

Caution!

During the first minute of the extinguishing phase, it is possible to relight the appliance by pressing  again. HOWEVER, this is no longer possible thereafter, for safety reasons. It is then necessary to wait until the appliance is completely extinguished (30 to 90 minutes) to be

able to restart it.

During this time, the appliance remains hot and will continue to radiate heat.

Some advice on getting the most out of your Stûv P-10

To make sure your device is working as well as it possible can, we also recommend:

- Activate the ash removal function every time before use and only when the device is switched off.
- Allow the device to go out completely at least every 20 hours.
- Alternate between different power settings.

- Avoid switching it off/on a lot repeatedly. Ideally, the ratio of the number of hours a stove is operating and the number of times it is lit should be more than or equal to 1.5. You can check these parameters in the "service" screen on the remote control [diagram 1].

MAINTENANCE

Daily maintenance

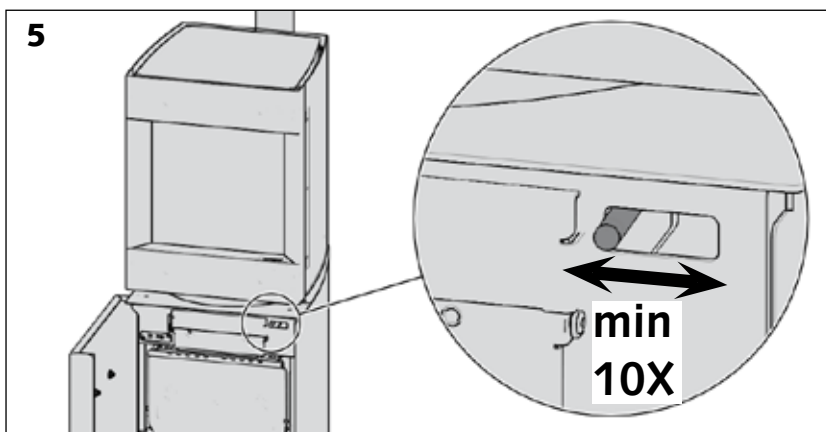
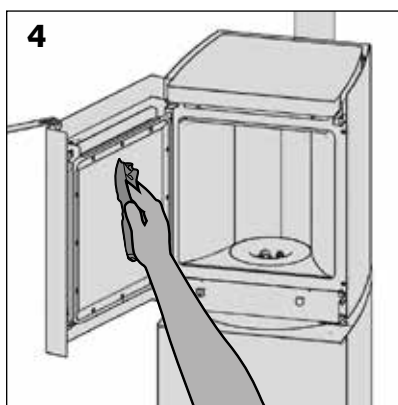
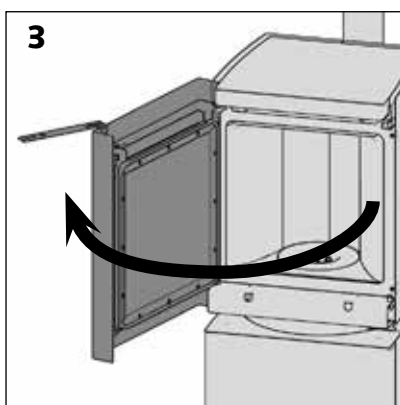
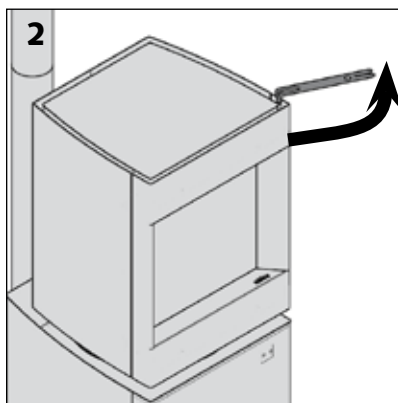
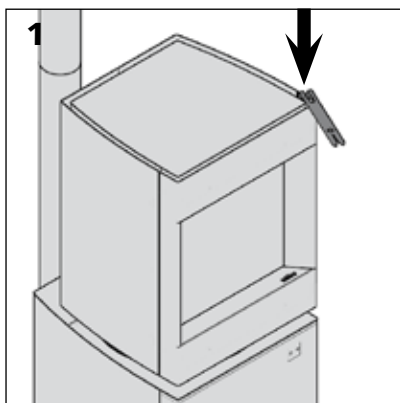

Be careful!

Wait until the stove has cooled down completely before carrying out maintenance.

Maintenance of the metal components

Use a dry cloth for cleaning.

Cleaning the glass

> Open the combustion chamber door using the control key [diagrams 1, 2 and 3].

> Clean the glass using a cleaning product specified for use on ordinary glass [diagram 4].

Caution!

The use of abrasive oven-cleaning products causes rapid destruction of the seals and damages the paintwork.

> Make sure the glass is properly dry because oily residues will set the smoke.

Ash Removal

Before lighting the appliance:

> Open the bottom door.

> Use the ash removal control, make ten movements from right to left [diagram 5].

> Check that in the end, the control returns to its original position (rod to the right).

NB!

Only remove the ash when the appliance is extinguished!

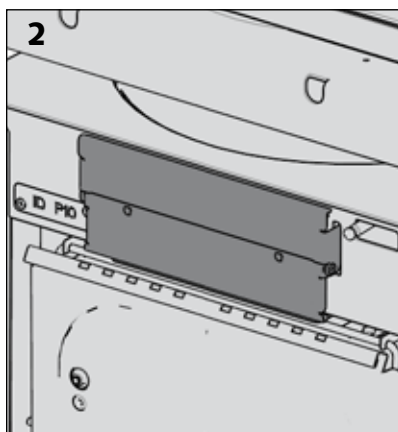
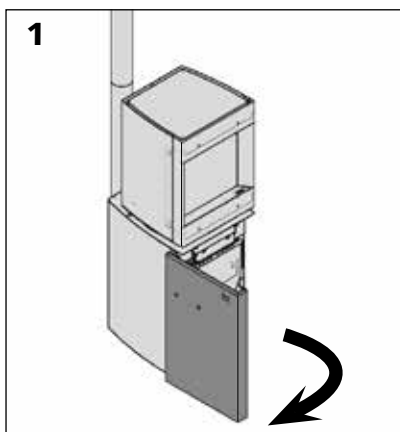

Warning!

Wait until the stove has cooled down completely before carrying out maintenance.

Emptying the ashpan and cleaning its housing

> Empty the ashpan for every 150 Kg of pellets burned.

Caution!

Only remove the ashpan when the stove is off.

Never touch the ashpan when the appliance is operating (risk of burns).

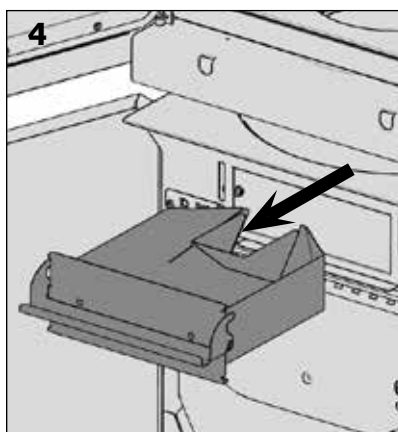
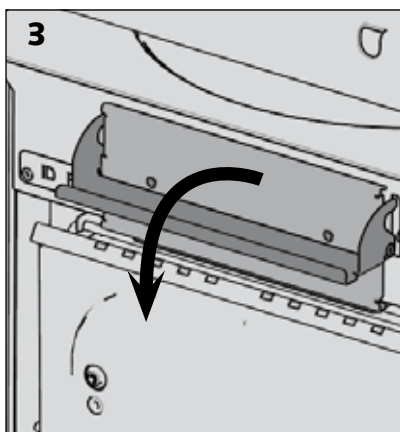

Ensure that the embers and ashes are cold before disposing of them in a container that can be burned or melted.

Once empty, put the ashpan back firmly into position, and make sure it is fully closed. If it is not, the device will emit a LEAK alarm.

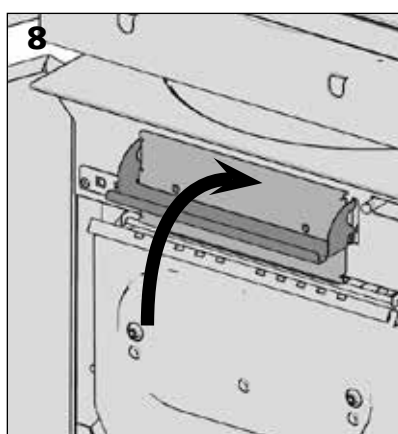
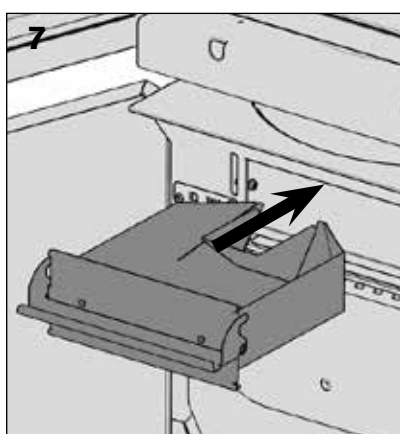
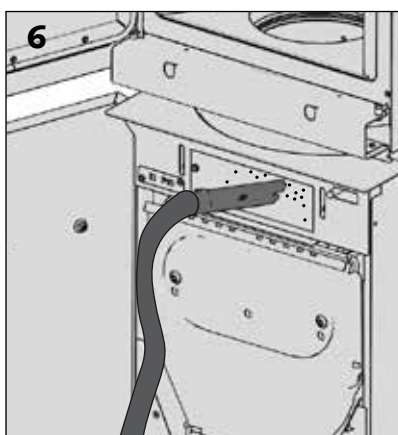
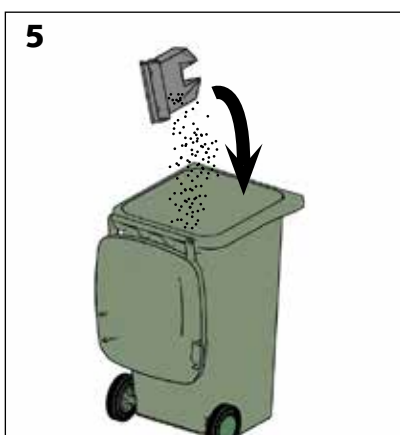

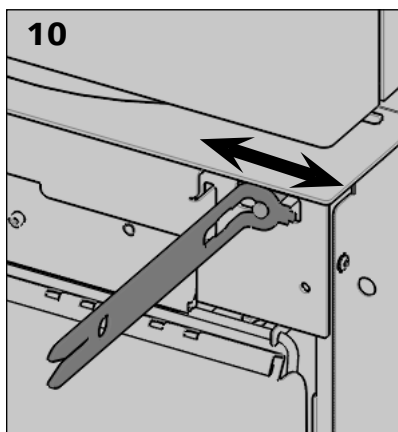
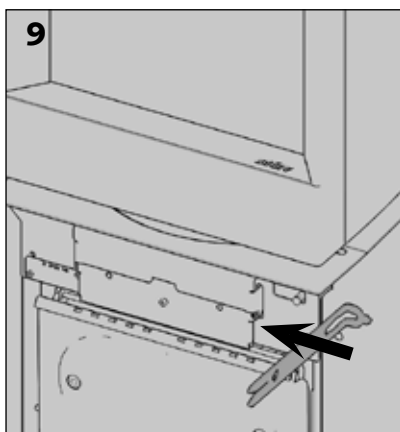

If you need to operate the grille or remove the ashpan when the appliance is hot, do these various operations using the control key.

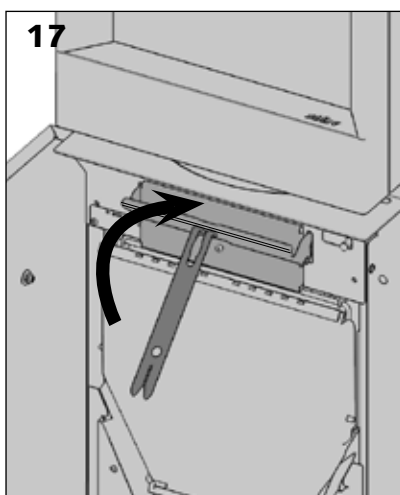
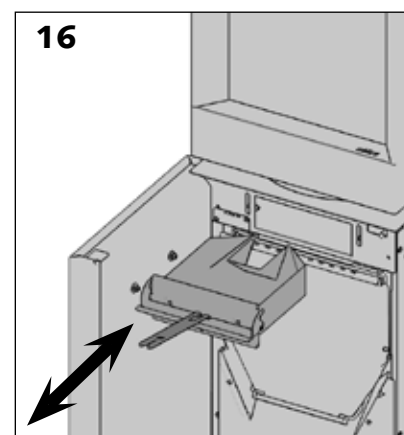
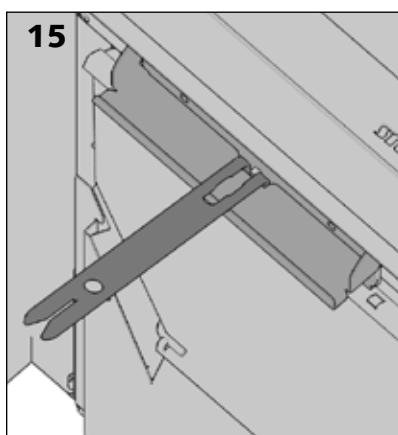
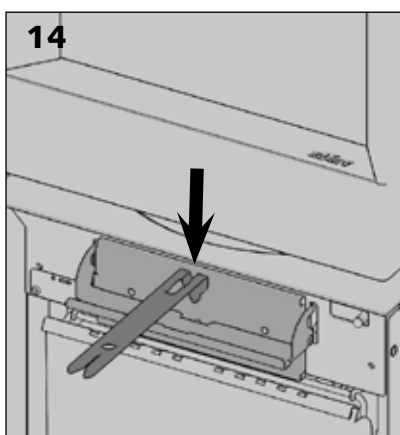
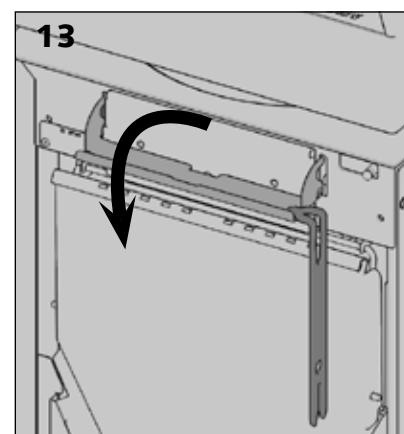
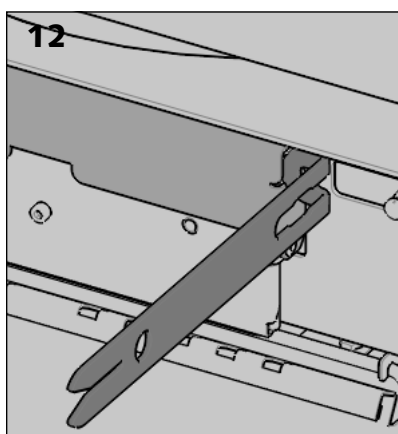
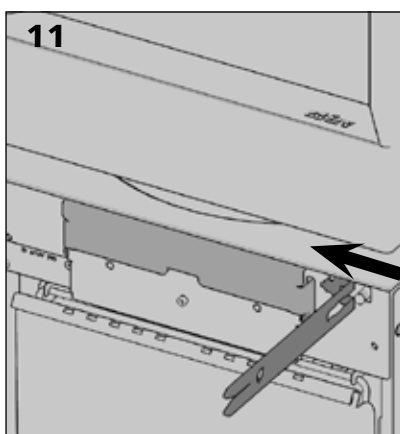

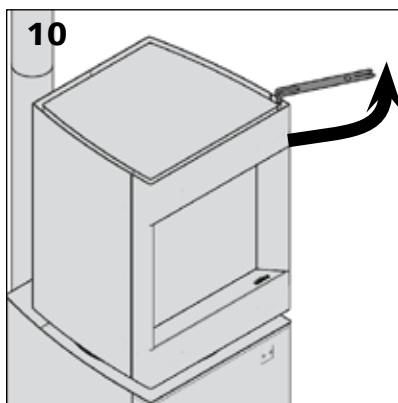
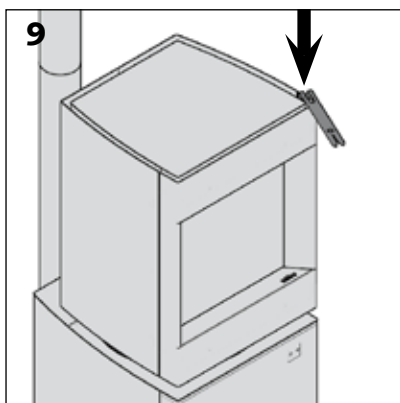

Cleaning the combustion chamber

- > Open the combustion chamber door using the control key [diagrams 9, 10 and 11].
- > Vacuum the inside of the combustion chamber [diagram 12].
- > Take care to close the door using the control key. Ensure that the door is securely locked.

Caution!

Do not open the door of the lantern while the unit is hot.

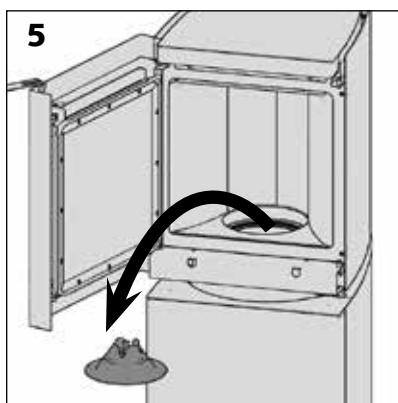
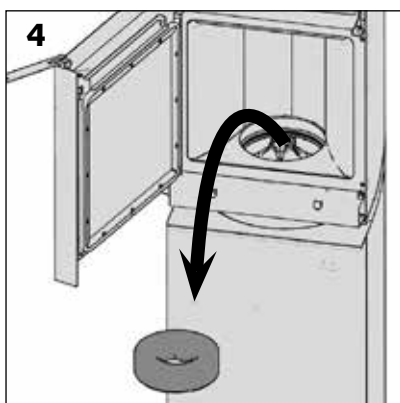
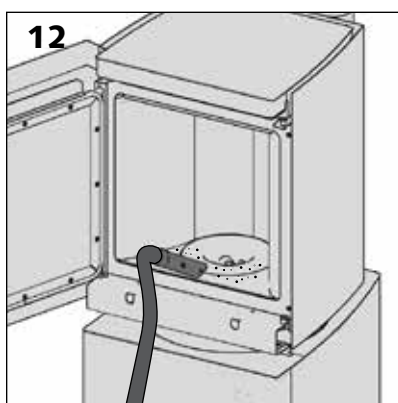
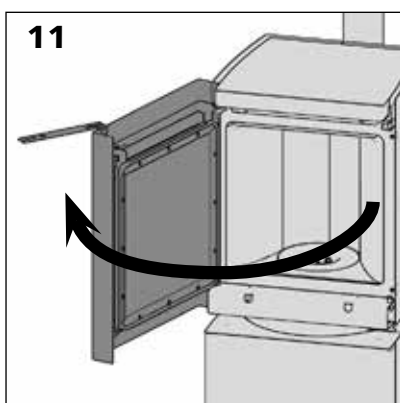

Cleaning the ash removal grille

- > Remove the vermiculite ring.
- > Remove the flame modeller.
- > Vacuum the grilles.

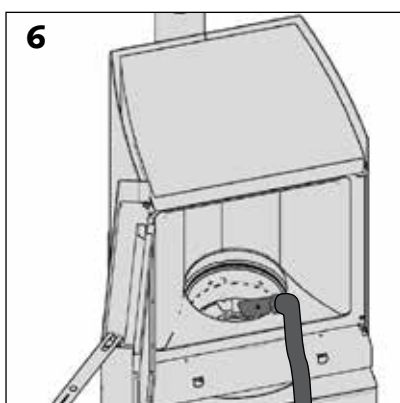

Annual maintenance for your Stûv P-10 is essential to make sure it works properly, and must be carried out by a **professional approved by Stûv**.

Once a year, or after operating for 1,500 hours (the remote control will display the message "CONTACT SER." to warn you that it's time to get in touch with the professional responsible for your device's maintenance [diagram 1]), you will need to:

- empty and clean the pellet hopper.

Warning!

Only fill the hopper when you next use the device (to avoid the pellets deteriorating).

- clean the extractor, its housing, the 2 smoke collectors and the pressure safety point
- clean the exchanger.
- clean the flue pipe to the chimney and sweep the chimney.
- check the door seal and replace if necessary.
- check the extractor seal and replace if necessary.
- check the pressure relief valve and replace if necessary.
- check the overheating indicator.
- check and clean the different parts of the burner.
- Re-start the counter calculating the number of hours the device is in operation before the next maintenance work needs to be carried out (in the "installer" menu on the remote control).

N.B.:

Stûv's statutory and extended guarantee are not valid for devices that have not been maintained as described above.

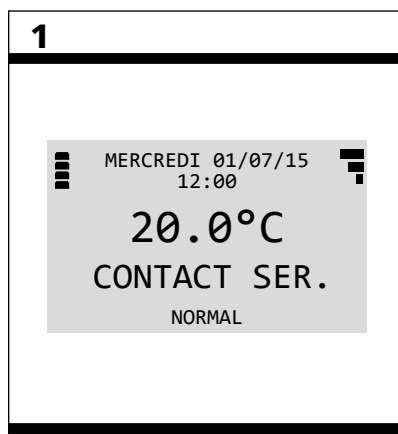

Annual maintenance

Make sure you keep this chart and ask your chimney expert to fill it in whenever they carry out maintenance work. In the event of a problem, Stûv's statutory and extended guarantee will only be valid for devices that have been maintained in accordance with the methods described in the previous chapter.

Date	Total operating hours	Sweeping	Cleaning the pellet hopper	Cleaning the smoke extractor	Cleaning the exchanger	Checking the seals	Checking the different parts of the burner	Restart hour counter	Carried out by	Comments (please note all alarms recorded etc.)
.....	<input type="checkbox"/>	<input type="checkbox"/>	<input type="checkbox"/>	<input type="checkbox"/>	<input type="checkbox"/>	<input type="checkbox"/>	<input type="checkbox"/>
.....	<input type="checkbox"/>	<input type="checkbox"/>	<input type="checkbox"/>	<input type="checkbox"/>	<input type="checkbox"/>	<input type="checkbox"/>	<input type="checkbox"/>
.....	<input type="checkbox"/>	<input type="checkbox"/>	<input type="checkbox"/>	<input type="checkbox"/>	<input type="checkbox"/>	<input type="checkbox"/>	<input type="checkbox"/>
.....	<input type="checkbox"/>	<input type="checkbox"/>	<input type="checkbox"/>	<input type="checkbox"/>	<input type="checkbox"/>	<input type="checkbox"/>	<input type="checkbox"/>
.....	<input type="checkbox"/>	<input type="checkbox"/>	<input type="checkbox"/>	<input type="checkbox"/>	<input type="checkbox"/>	<input type="checkbox"/>	<input type="checkbox"/>
.....	<input type="checkbox"/>	<input type="checkbox"/>	<input type="checkbox"/>	<input type="checkbox"/>	<input type="checkbox"/>	<input type="checkbox"/>	<input type="checkbox"/>
.....	<input type="checkbox"/>	<input type="checkbox"/>	<input type="checkbox"/>	<input type="checkbox"/>	<input type="checkbox"/>	<input type="checkbox"/>	<input type="checkbox"/>
.....	<input type="checkbox"/>	<input type="checkbox"/>	<input type="checkbox"/>	<input type="checkbox"/>	<input type="checkbox"/>	<input type="checkbox"/>	<input type="checkbox"/>
.....	<input type="checkbox"/>	<input type="checkbox"/>	<input type="checkbox"/>	<input type="checkbox"/>	<input type="checkbox"/>	<input type="checkbox"/>	<input type="checkbox"/>
.....	<input type="checkbox"/>	<input type="checkbox"/>	<input type="checkbox"/>	<input type="checkbox"/>	<input type="checkbox"/>	<input type="checkbox"/>	<input type="checkbox"/>
.....	<input type="checkbox"/>	<input type="checkbox"/>	<input type="checkbox"/>	<input type="checkbox"/>	<input type="checkbox"/>	<input type="checkbox"/>	<input type="checkbox"/>
.....	<input type="checkbox"/>	<input type="checkbox"/>	<input type="checkbox"/>	<input type="checkbox"/>	<input type="checkbox"/>	<input type="checkbox"/>	<input type="checkbox"/>
.....	<input type="checkbox"/>	<input type="checkbox"/>	<input type="checkbox"/>	<input type="checkbox"/>	<input type="checkbox"/>	<input type="checkbox"/>	<input type="checkbox"/>
.....	<input type="checkbox"/>	<input type="checkbox"/>	<input type="checkbox"/>	<input type="checkbox"/>	<input type="checkbox"/>	<input type="checkbox"/>	<input type="checkbox"/>
.....	<input type="checkbox"/>	<input type="checkbox"/>	<input type="checkbox"/>	<input type="checkbox"/>	<input type="checkbox"/>	<input type="checkbox"/>	<input type="checkbox"/>
.....	<input type="checkbox"/>	<input type="checkbox"/>	<input type="checkbox"/>	<input type="checkbox"/>	<input type="checkbox"/>	<input type="checkbox"/>	<input type="checkbox"/>
.....	<input type="checkbox"/>	<input type="checkbox"/>	<input type="checkbox"/>	<input type="checkbox"/>	<input type="checkbox"/>	<input type="checkbox"/>	<input type="checkbox"/>
.....	<input type="checkbox"/>	<input type="checkbox"/>	<input type="checkbox"/>	<input type="checkbox"/>	<input type="checkbox"/>	<input type="checkbox"/>	<input type="checkbox"/>
.....	<input type="checkbox"/>	<input type="checkbox"/>	<input type="checkbox"/>	<input type="checkbox"/>	<input type="checkbox"/>	<input type="checkbox"/>	<input type="checkbox"/>
.....	<input type="checkbox"/>	<input type="checkbox"/>	<input type="checkbox"/>	<input type="checkbox"/>	<input type="checkbox"/>	<input type="checkbox"/>	<input type="checkbox"/>
.....	<input type="checkbox"/>	<input type="checkbox"/>	<input type="checkbox"/>	<input type="checkbox"/>	<input type="checkbox"/>	<input type="checkbox"/>	<input type="checkbox"/>
.....	<input type="checkbox"/>	<input type="checkbox"/>	<input type="checkbox"/>	<input type="checkbox"/>	<input type="checkbox"/>	<input type="checkbox"/>	<input type="checkbox"/>
.....	<input type="checkbox"/>	<input type="checkbox"/>	<input type="checkbox"/>	<input type="checkbox"/>	<input type="checkbox"/>	<input type="checkbox"/>	<input type="checkbox"/>
.....	<input type="checkbox"/>	<input type="checkbox"/>	<input type="checkbox"/>	<input type="checkbox"/>	<input type="checkbox"/>	<input type="checkbox"/>	<input type="checkbox"/>
.....	<input type="checkbox"/>	<input type="checkbox"/>	<input type="checkbox"/>	<input type="checkbox"/>	<input type="checkbox"/>	<input type="checkbox"/>	<input type="checkbox"/>
.....	<input type="checkbox"/>	<input type="checkbox"/>	<input type="checkbox"/>	<input type="checkbox"/>	<input type="checkbox"/>	<input type="checkbox"/>	<input type="checkbox"/>
.....	<input type="checkbox"/>	<input type="checkbox"/>	<input type="checkbox"/>	<input type="checkbox"/>	<input type="checkbox"/>	<input type="checkbox"/>	<input type="checkbox"/>
.....	<input type="checkbox"/>	<input type="checkbox"/>	<input type="checkbox"/>	<input type="checkbox"/>	<input type="checkbox"/>	<input type="checkbox"/>	<input type="checkbox"/>
.....	<input type="checkbox"/>	<input type="checkbox"/>	<input type="checkbox"/>	<input type="checkbox"/>	<input type="checkbox"/>	<input type="checkbox"/>	<input type="checkbox"/>
.....	<input type="checkbox"/>	<input type="checkbox"/>	<input type="checkbox"/>	<input type="checkbox"/>	<input type="checkbox"/>	<input type="checkbox"/>	<input type="checkbox"/>
.....	<input type="checkbox"/>	<input type="checkbox"/>	<input type="checkbox"/>	<input type="checkbox"/>	<input type="checkbox"/>	<input type="checkbox"/>	<input type="checkbox"/>
.....	<input type="checkbox"/>	<input type="checkbox"/>	<input type="checkbox"/>	<input type="checkbox"/>	<input type="checkbox"/>	<input type="checkbox"/>	<input type="checkbox"/>
.....	<input type="checkbox"/>	<input type="checkbox"/>	<input type="checkbox"/>	<input type="checkbox"/>	<input type="checkbox"/>	<input type="checkbox"/>	<input type="checkbox"/>
.....	<input type="checkbox"/>	<input type="checkbox"/>	<input type="checkbox"/>	<input type="checkbox"/>	<input type="checkbox"/>	<input type="checkbox"/>	<input type="checkbox"/>
.....	<input type="checkbox"/>	<input type="checkbox"/>	<input type="checkbox"/>	<input type="checkbox"/>	<input type="checkbox"/>	<input type="checkbox"/>	<input type="checkbox"/>
.....	<input type="checkbox"/>	<input type="checkbox"/>	<input type="checkbox"/>	<input type="checkbox"/>	<input type="checkbox"/>	<input type="checkbox"/>	<input type="checkbox"/>
.....	<input type="checkbox"/>	<input type="checkbox"/>	<input type="checkbox"/>	<input type="checkbox"/>	<input type="checkbox"/>	<input type="checkbox"/>	<input type="checkbox"/>
.....	<input type="checkbox"/>	<input type="checkbox"/>	<input type="checkbox"/>	<input type="checkbox"/>	<input type="checkbox"/>	<input type="checkbox"/>	<input type="checkbox"/>
.....	<input type="checkbox"/>	<input type="checkbox"/>	<input type="checkbox"/>	<input type="checkbox"/>	<input type="checkbox"/>	<input type="checkbox"/>	<input type="checkbox"/>
.....	<input type="checkbox"/>	<input type="checkbox"/>	<input type="checkbox"/>	<input type="checkbox"/>	<input type="checkbox"/>	<input type="checkbox"/>	<input type="checkbox"/>
.....	<input type="checkbox"/>	<input type="checkbox"/>	<input type="checkbox"/>	<input type="checkbox"/>	<input type="checkbox"/>	<input type="checkbox"/>	<input type="checkbox"/>
.....	<input type="checkbox"/>	<input type="checkbox"/>	<input type="checkbox"/>	<input type="checkbox"/>	<input type="checkbox"/>	<input type="checkbox"/>	<input type="checkbox"/>
.....	<input type="checkbox"/>	<input type="checkbox"/>	<input type="checkbox"/>	<input type="checkbox"/>	<input type="checkbox"/>	<input type="checkbox"/>	<input type="checkbox"/>
.....	<input type="checkbox"/>	<input type="checkbox"/>	<input type="checkbox"/>	<input type="checkbox"/>	<input type="checkbox"/>	<input type="checkbox"/>	<input type="checkbox"/>
.....	<input type="checkbox"/>	<input type="checkbox"/>	<input type="checkbox"/>	<input type="checkbox"/>	<input type="checkbox"/>	<input type="checkbox"/>	<input type="checkbox"/>
.....	<input type="checkbox"/>	<input type="checkbox"/>	<input type="checkbox"/>	<input type="checkbox"/>	<input type="checkbox"/>	<input type="checkbox"/>	<input type="checkbox"/>
.....	<input type="checkbox"/>	<input type="checkbox"/>	<input type="checkbox"/>	<input type="checkbox"/>	<input type="checkbox"/>	<input type="checkbox"/>	<input type="checkbox"/>
.....	<input type="checkbox"/>	<input type="checkbox"/>	<input type="checkbox"/>	<input type="checkbox"/>	<input type="checkbox"/>	<input type="checkbox"/>	<input type="checkbox"/>
.....	<input type="checkbox"/>	<input type="checkbox"/>	<input type="checkbox"/>	<input type="checkbox"/>	<input type="checkbox"/>	<input type="checkbox"/>	<input type="checkbox"/>
.....	<input type="checkbox"/>	<input type="checkbox"/>	<input type="checkbox"/>	<input type="checkbox"/>	<input type="checkbox"/>	<input type="checkbox"/>	<input type="checkbox"/>
.....	<input type="checkbox"/>	<input type="checkbox"/>	<input type="checkbox"/>	<input type="checkbox"/>	<input type="checkbox"/>	<input type="checkbox"/>	<input type="checkbox"/>
.....	<input type="checkbox"/>	<input type="checkbox"/>	<input type="checkbox"/>	<input type="checkbox"/>	<input type="checkbox"/>	<input type="checkbox"/>	<input type="checkbox"/>
.....	<input type="checkbox"/>	<input type="checkbox"/>	<input type="checkbox"/>	<input type="checkbox"/>	<input type="checkbox"/>	<input type="checkbox"/>	<input type="checkbox"/>
.....	<input type="checkbox"/>	<input type="checkbox"/>	<input type="checkbox"/>	<input type="checkbox"/>	<input type="checkbox"/>	<input type="checkbox"/>	<input type="checkbox"/>
.....	<input type="checkbox"/>	<input type="checkbox"/>	<input type="checkbox"/>	<input type="checkbox"/>	<input type="checkbox"/>	<input type="checkbox"/>	<input type="checkbox"/>
.....	<input type="checkbox"/>	<input type="checkbox"/>	<input type="checkbox"/>	<input type="checkbox"/>	<input type="checkbox"/>	<input type="checkbox"/>	<input type="checkbox"/>
.....	<input type="checkbox"/>	<input type="checkbox"/>	<input type="checkbox"/>	<input type="checkbox"/>	<input type="checkbox"/>	<input type="checkbox"/>	<input type="checkbox"/>
.....	<input type="checkbox"/>	<input type="checkbox"/>	<input type="checkbox"/>	<input type="checkbox"/>	<input type="checkbox"/>	<input type="checkbox"/>	<input type="checkbox"/>
.....	<input type="checkbox"/>	<input type="checkbox"/>	<input type="checkbox"/>	<input type="checkbox"/>	<input type="checkbox"/>	<input type="checkbox"/>	<input type="checkbox"/>
.....	<input type="checkbox"/>	<input type="checkbox"/>	<input type="checkbox"/>	<input type="checkbox"/>	<input type="checkbox"/>	<input type="checkbox"/>	<input type="checkbox"/>
.....	<input type="checkbox"/>	<input type="checkbox"/>	<input type="checkbox"/>	<input type="checkbox"/>	<input type="checkbox"/>	<input type="checkbox"/>	<input type="checkbox"/>
.....	<input type="checkbox"/>	<input type="checkbox"/>	<input type="checkbox"/>	<input type="checkbox"/>	<input type="checkbox"/>	<input type="checkbox"/>	<input type="checkbox"/>
.....	<input type="checkbox"/>	<input type="checkbox"/>	<input type="checkbox"/>	<input type="checkbox"/>	<input type="checkbox"/>	<input type="checkbox"/>	<input type="checkbox"/>
.....	<input type="checkbox"/>	<input type="checkbox"/>	<input type="checkbox"/>	<input type="checkbox"/>	<input type="checkbox"/>	<input type="checkbox"/>	<input type="checkbox"/>
.....	<input type="checkbox"/>	<input type="checkbox"/>	<input type="checkbox"/>	<input type="checkbox"/>	<input type="checkbox"/>	<input type="checkbox"/>	<input type="checkbox"/>
.....	<input type="checkbox"/>	<input type="checkbox"/>	<input type="checkbox"/>	<input type="checkbox"/>	<input type="checkbox"/>	<input type="checkbox"/>	<input type="checkbox"/>
.....	<input type="checkbox"/>	<input type="checkbox"/>	<input type="checkbox"/>	<input type="checkbox"/>	<input type="checkbox"/>	<input type="checkbox"/>	<input type="checkbox"/>
.....	<input type="checkbox"/>	<input type="checkbox"/>	<input type="checkbox"/>	<input type="checkbox"/>	<input type="checkbox"/>	<input type="checkbox"/>	<input type="checkbox"/>
.....	<input type="checkbox"/>	<input type="checkbox"/>	<input type="checkbox"/>	<input type="checkbox"/>	<input type="checkbox"/>	<input type="checkbox"/>	<input type="checkbox"/>
.....	<input type="checkbox"/>	<input type="checkbox"/>	<input type="checkbox"/>	<input type="checkbox"/>	<input type="checkbox"/>	<input type="checkbox"/>	<input type="checkbox"/>
.....	<input type="checkbox"/>	<input type="checkbox"/>	<input type="checkbox"/>	<input type="checkbox"/>	<input type="checkbox"/>	<input type="checkbox"/>	<input type="checkbox"/>
.....	<input type="checkbox"/>	<input type="checkbox"/>	<input type="checkbox"/>	<input type="checkbox"/>	<input type="checkbox"/>	<input type="checkbox"/>	<input type="checkbox"/>
.....	<input type="checkbox"/>	<input type="checkbox"/>	<input type="checkbox"/>	<input type="checkbox"/>	<input type="checkbox"/>	<input type="checkbox"/>	<input type="checkbox"/>
.....	<input type="checkbox"/>	<input type="checkbox"/>	<input type="checkbox"/>	<input type="checkbox"/>	<input type="checkbox"/>	<input type="checkbox"/>	<input type="checkbox"/>
.....	<input type="checkbox"/>	<input type="checkbox"/>	<input type="checkbox"/>	<input type="checkbox"/>	<input type="checkbox"/>	<input type="checkbox"/>	<input type="checkbox"/>
.....	<input type="checkbox"/>	<input type="checkbox"/>	<input type="checkbox"/>	<input type="checkbox"/>	<input type="checkbox"/>	<input type="checkbox"/>	<input type="checkbox"/>
.....	<input type="checkbox"/>	<input type="checkbox"/>	<input type="checkbox"/>	<input type="checkbox"/>	<input type="checkbox"/>	<input type="checkbox"/>	<input type="checkbox"/>
.....	<input type="checkbox"/>	<input type="checkbox"/>	<input type="checkbox"/>	<input type="checkbox"/>	<input type="checkbox"/>	<input type="checkbox"/>	<input type="checkbox"/>
.....	<input type="checkbox"/>	<input type="checkbox"/>	<input type="checkbox"/>	<input type="checkbox"/>	<input type="checkbox"/>	<input type="checkbox"/>	<input type="checkbox"/>
.....	<input type="checkbox"/>	<input type="checkbox"/>	<input type="checkbox"/>	<input type="checkbox"/>	<input type="checkbox"/>	<input type="checkbox"/>	<input type="checkbox"/>
.....	<input type="checkbox"/>	<input type="checkbox"/>	<input type="checkbox"/>	<input type="checkbox"/>	<input type="checkbox"/>	<input type="checkbox"/>	<input type="checkbox"/>
.....	<input type="checkbox"/>	<input type="checkbox"/>	<input type="checkbox"/>	<input type="checkbox"/>	<input type="checkbox"/>	<input type="checkbox"/>	<input type="checkbox"/>
.....	<input type="checkbox"/>	<input type="checkbox"/>	<input type="checkbox"/>	<input type="checkbox"/>	<input type="checkbox"/>	<input type="checkbox"/>	<input type="checkbox"/>
.....	<input type="checkbox"/>	<input type="checkbox"/>	<input type="checkbox"/>	<input type="checkbox"/>	<input type="checkbox"/>	<input type="checkbox"/>	<input type="checkbox"/>
.....	<input type="checkbox"/>	<input type="checkbox"/>	<input type="checkbox"/>	<input type="checkbox"/>	<input type="checkbox"/>	<input type="checkbox"/>	<input type="checkbox"/>
.....	<input type="checkbox"/>	<input type="checkbox"/>	<input type="checkbox"/>	<input type="checkbox"/>	<input type="checkbox"/>	<input type="checkbox"/>	<input type="checkbox"/>
.....	<input type="checkbox"/>	<input type="checkbox"/>	<input type="checkbox"/>	<input type="checkbox"/>	<input type="checkbox"/>	<input type="checkbox"/>	<input type="checkbox"/>
.....	<input type="checkbox"/>	<input type="checkbox"/>	<input type="checkbox"/>	<input type="checkbox"/>	<input type="checkbox"/>	<input type="checkbox"/>	<input type="checkbox"/>
.....	<input type="checkbox"/>	<input type="checkbox"/>	<input type="checkbox"/>	<input type="checkbox"/>	<input type="checkbox"/>	<input type="checkbox"/>	<input type="checkbox"/>
.....	<input type="checkbox"/>	<input type="checkbox"/>	<input type="checkbox"/>	<input type="checkbox"/>	<input type="checkbox"/>	<input type="checkbox"/>	<input type="checkbox"/>
.....	<input type="checkbox"/>	<input type="checkbox"/>	<input type="checkbox"/>	<input type="checkbox"/>	<input type="checkbox"/>	<input type="checkbox"/>	<input type="checkbox"/>
.....	<input type="checkbox"/>	<input type="checkbox"/>	<input type="checkbox"/>	<input type="checkbox"/>	<input type="checkbox"/>	<input type="checkbox"/>	<input type="checkbox"/>
.....	<input type="checkbox"/>	<input type="checkbox"/>	<input type="checkbox"/>	<input type="checkbox"/>	<input type="checkbox"/>	<input type="checkbox"/>	<input type="checkbox"/>
.....	<input type="checkbox"/>	<input type="checkbox"/>	<input type="checkbox"/>	<input type="checkbox"/>	<input type="checkbox"/>	<input type="checkbox"/>	<input type="checkbox"/>
.....	<input type="checkbox"/>	<input type="checkbox"/>	<input type="checkbox"/>	<input type="checkbox"/>	<input type="checkbox"/>	<input type="checkbox"/>	<input type="checkbox"/>
.....	<input type="checkbox"/>	<input type="checkbox"/>	<input type="checkbox"/>	<input type="checkbox"/>	<input type="checkbox"/>	<input type="checkbox"/>	<input type="checkbox"/>
.....	<input type="checkbox"/>	<input type="checkbox"/>	<input type="checkbox"/>	<input type="checkbox"/>	<input type="checkbox"/>	<input type="checkbox"/>	<input type="checkbox"/>
.....	<input type="checkbox"/>	<input type="checkbox"/>	<input type="checkbox"/>	<input type="checkbox"/>	<input type="checkbox"/>	<input type="checkbox"/>	<input type="checkbox"/>
.....	<input type="checkbox"/>	<input type="checkbox"/>	<input type="checkbox"/>	<input type="checkbox"/>	<input type="checkbox"/>	<input type="checkbox"/>	<input type="checkbox"/>
.....	<input type="checkbox"/>	<input type="checkbox"/>	<input type="checkbox"/>	<input type="checkbox"/>	<input type="checkbox"/>	<input type="checkbox"/>	<input type="checkbox"/>
.....	<input type="checkbox"/>	<input type="checkbox"/>	<input type="checkbox"/>	<input type="checkbox"/>	<input type="checkbox"/>	<input type="checkbox"/>	<input type="checkbox"/>
.....	<input type="checkbox"/>	<input type="checkbox"/>	<input type="checkbox"/>	<input type="checkbox"/>	<input type="checkbox"/>	<input type="checkbox"/>	<input type="checkbox"/>
.....	<input type="checkbox"/>	<input type="checkbox"/>	<input type="checkbox"/>	<input type="checkbox"/>	<input type="checkbox"/>	<input type="checkbox"/>	<input type="checkbox"/>
.....	<input type="checkbox"/>	<input type="checkbox"/>	<input type="checkbox"/>	<input type="checkbox"/>	<input type="checkbox"/>	<input type="checkbox"/>	<input type="checkbox"/>
.....	<input type="checkbox"/>	<input type="checkbox"/>	<input type="checkbox"/>	<input type="checkbox"/>	<input type="checkbox"/>	<input type="checkbox"/>	<input type="checkbox"/>
.....	<input type="checkbox"/>	<input type="checkbox"/>	<input type="checkbox"/>	<input type="checkbox"/>	<input type="checkbox"/>	<input type="checkbox"/>	<input type="checkbox"/>
.....	<input type="checkbox"/>	<input type="checkbox"/>	<input type="checkbox"/>	<input type="checkbox"/>	<input type="checkbox"/>	<input type="checkbox"/>	<input type="checkbox"/>
.....	<input type="checkbox"/>	<input type="checkbox"/>	<input type="checkbox"/>	<input type="checkbox"/>	<input type="checkbox"/>	<input type="checkbox"/>	<input type="checkbox"/>
.....	<input type="checkbox"/>	<input type="checkbox"/>	<input type="checkbox"/>	<input type="checkbox"/>	<input type="checkbox"/>	<input type="checkbox"/>	<input type="checkbox"/>
.....	<input type="checkbox"/>	<input type="checkbox"/>	<input type="checkbox"/>	<input type="checkbox"/>	<input type="checkbox"/>	<input type="checkbox"/>	<input type="checkbox"/>
.....	<input type="checkbox"/>	<input type="checkbox"/>	<input type="checkbox"/>	<input type="checkbox"/>	<input type="checkbox"/>	<input type="checkbox"/>	<input type="checkbox"/>
.....	<input type="checkbox"/>	<input type="checkbox"/>	<input type="checkbox"/>	<input type="checkbox"/>	<input type="checkbox"/>	<input type="checkbox"/>	<input type="checkbox"/>
.....	<input type="checkbox"/>	<input type="checkbox"/>	<input type="checkbox"/>	<input type="checkbox"/>	<input type="checkbox"/>	<input type="checkbox"/>	<input type="checkbox"/>
.....	<input type="checkbox"/>	<input type="checkbox"/>	<input type="checkbox"/>	<input type="checkbox"/>	<input type="checkbox"/>	<input type="checkbox"/>	<input type="checkbox"/>
.....	<input type="checkbox"/>	<input type="checkbox"/>	<input type="checkbox"/>	<input type="checkbox"/>	<input type="checkbox"/>	<input type="checkbox"/>	<input type="checkbox"/>
.....	<input type="checkbox"/>	<input type="checkbox"/>	<input type="checkbox"/>	<input type="checkbox"/>	<input type="checkbox"/>	<input type="checkbox"/>	<input type="checkbox"/>
.....	<input type="checkbox"/>	<input type="checkbox"/>	<input type="checkbox"/>	<input type="checkbox"/>	<input type="checkbox"/>	<input type="checkbox"/>	<input type="checkbox"/>
.....	<input type="checkbox"/>	<input type="checkbox"/>	<input type="checkbox"/>	<input type="checkbox"/>	<input type="checkbox"/>	<input type="checkbox"/>	<input type="checkbox"/>
.....	<input type="checkbox"/>	<input type="checkbox"/>	<input type="checkbox"/>	<input type="checkbox"/>	<input type="checkbox"/>	<input type="checkbox"/>	<input type="checkbox"/>
.....	<input type="checkbox"/>	<input type="checkbox"/>	<input type="checkbox"/>	<input type="checkbox"/>	<input type="checkbox"/>	<input type="checkbox"/>	<input type="checkbox"/>
.....	<input type="checkbox"/>	<input type="checkbox"/>	<input type="checkbox"/>	<input type="checkbox"/>	<input type="checkbox"/>	<input type="checkbox"/>	<input type="checkbox"/>
.....	<input type="checkbox"/>	<input type="checkbox"/>	<input type="checkbox"/>	<input type="checkbox"/>	<input type="checkbox"/>	<input type="checkbox"/>	<input type="checkbox"/>
.....	<input type="checkbox"/>	<input type="checkbox"/>	<input type="checkbox"/>	<input type="checkbox"/>	<input type="checkbox"/>	<input type="checkbox"/>	<input type="checkbox"/>
.....	<input type="checkbox"/>	<input type="checkbox"/>	<input type="checkbox"/>	<input type="checkbox"/>	<input type="checkbox"/>	<input type="checkbox"/>	<input type="checkbox"/>
.....	<input type="checkbox"/>	<input type="checkbox"/>	<input type="checkbox"/>	<input type="checkbox"/>	<input type="checkbox"/>	<input type="checkbox"/>	<input type="checkbox"/>
.....	<input type="checkbox"/>	<input type="checkbox"/>	<input type="checkbox"/>	<input type="checkbox"/>	<input type="checkbox"/>	<input type="checkbox"/>	<input type="checkbox"/>
.....	<input type="checkbox"/>	<input type="checkbox"/>	<input type="checkbox"/>	<input type="checkbox"/>	<input type="checkbox"/>	<input type="checkbox"/>	<input type="checkbox"/>
.....	<input type="checkbox"/>	<input type="checkbox"/>	<input type="checkbox"/>	<input type="checkbox"/>	<input type="checkbox"/>	<input type="checkbox"/>	<input type="checkbox"/>
.....	<input type="checkbox"/>	<input type="checkbox"/>	<input type="checkbox"/>	<input type="checkbox"/>	<input type="checkbox"/>	<input type="checkbox"/>	<input type="checkbox"/>
.....	<input type="checkbox"/>	<input type="checkbox"/>	<input type="checkbox"/>	<input type="checkbox"/>	<input type="checkbox"/>	<input type="checkbox"/>	<input type="checkbox"/>
.....	<input type="checkbox"/>	<input type="checkbox"/>	<input type="checkbox"/>	<input type="checkbox"/>	<input type="checkbox"/>	<input type="checkbox"/>	<input type="checkbox"/>
.....	<input type="checkbox"/>	<input type="checkbox"/>	<input type="checkbox"/>						

IN CASE OF PROBLEMS...

Emergency switch

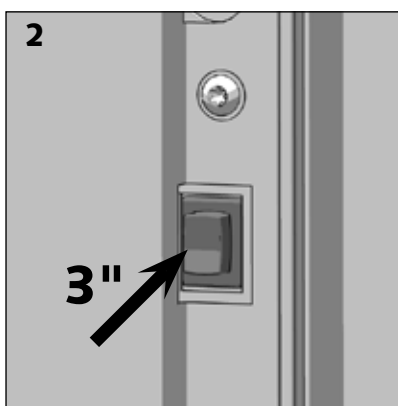
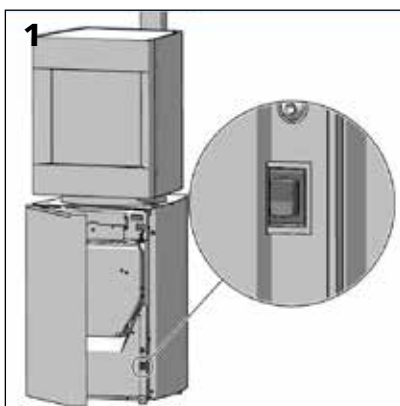



In the event of a malfunction or if the remote control is lost, the appliance is equipped with an emergency stop switch [Figure 1].

Press for 5 seconds on the switch and the stove goes into blackout mode [Figure 2].

This switch may also be used in the same way to turn the stove on, if necessary. The appliance will then start in the last mode used (except for calendar mode). However, we recommend that the use of the remote control is preferable.

Acknowledgement of an alarm.

When an alarm occurs, the stove emits a sound signal, to warn you. To indicate that the user has acknowledged the phenomenon, it is necessary to press and hold the button  (NB: in the case of some alarms, a 5 minute delay is required before being able to cancel the alarm by pressing .) Once this operation has been carried

out, the stove goes into "cooling" mode.

Reminder:
Putting the appliance into alarm mode deactivates calendar mode.

Alarm signals



"No flame" alarm

This alarm indicates an abnormally low smoke temperature signifying that the flame is probably out.

If this alarm is displayed:

- > Wait for 5 minutes then make a note of the alarm and clear it by pressing and holding 
- > Let the device go out
- > Once the device has gone out and cooled down, remove the ash, making sure that **no unburned pellets are left on the burner grille** and empty the ash pan.
- > Make sure there are still enough pellets in the hopper. If not, fill the hopper and try to light the device again. If the alarm starts again, contact the installer.
- > If the hopper is full or the alarm is displayed when there is a flame, contact the installer.



Negative pressure alarm

This alarm indicates a pressure switch malfunction or a lack of negative pressure.

If this alarm is displayed:

- > Wait for 5 minutes then make a note of the alarm and clear it by pressing and holding 
- > Let the device go out
- > **Once the device has gone out and cooled down, remove the ash and empty the ash pan.**
- > Restart the device. If the alarm starts again, contact the installer.



"No ignition" alarm

This alarm indicates an ignition fault.

If this alarm is displayed:

- > Wait for 5 minutes then make a note of the alarm and clear it by pressing and holding 
- > Let the device go out
- > **Warning!**
Once the device has gone out and cooled down, **remove the ash and thoroughly clean the burner grille (see chapter entitled "weekly maintenance"), making sure that no unburned pellets are left on the burner grill then empty the ashpan.**
- > Make sure there are still enough pellets in the hopper.
If not, fill the hopper.
- > Restart the device. If the alarm starts again, contact the installer.



Archimedes screw 1 alarm

This alarm indicates a malfunction of the primary screw or its speed sensor.

If this alarm is displayed:

- > Wait for 5 minutes then make a note of the alarm and clear it by pressing and holding 
- > Let the device go out
- > Contact the installer.



"Archimedes screw 2" alarm

This alarm indicates a malfunction of the secondary screw or its speed sensor.

If this alarm is displayed:

- > Wait for 5 minutes then make a note of the alarm and clear it by pressing and holding 
- > Let the device go out
- > **Once the device has gone out and cooled down, remove the ash and thoroughly clean the burner grille (see chapter entitled "weekly maintenance"), making sure that the pellet feed tube is not blocked by a clump of ash or unburned pellets. If necessary, clean the end of the tube with a vacuum cleaner.**
- > Restart the device. If the alarm starts again, contact the installer.

Alarm signals (continued)

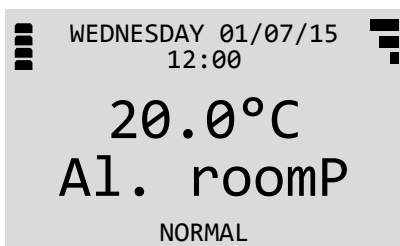

"Ambient sensor" alarm

This alarm indicates a malfunction of the ambient temperature sensor on the appliance.

If this alarm is displayed:

- > Wait for 5 minutes then make a note of the alarm and clear it by pressing and holding 
- > Let the device go out
- > Contact the installer.

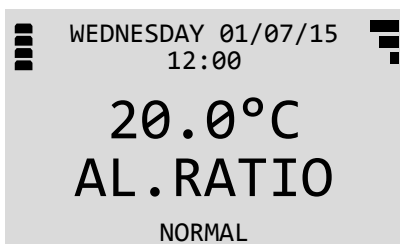

"Ratio" alarm

This alarm indicates a poor speed ratio between screws 1 & 2.

If this alarm is displayed:

- > Wait for 5 minutes then make a note of the alarm and clear it by pressing and holding 
- > Let the device go out
- > Contact the installer.



"Safety" alarm

This alarm indicates that the appliance is overheating.

If this alarm is displayed:

- > Wait for 5 minutes then make a note of the alarm and clear it by pressing and holding 
- > Let the device go out
- > Once the device has gone out and cooled down, **remove the ash and thoroughly clean the burner grille (see chapter entitled "weekly maintenance")**.
- > Make sure that the grille is in the correct position [diagram 1].
- > Rearm the safety switch. The red button on the switch will only reararm if the device is cool [diagram 2].
- > Restart the device. If the alarm starts again, contact the installer.

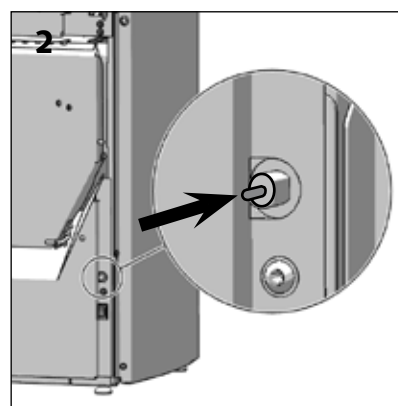
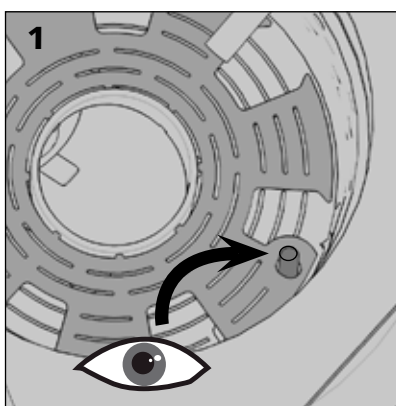

"Smoke sensor" alarm

This alarm indicates a malfunction of the smoke temperature sensor on the appliance.

If this alarm is displayed:

- > Wait for 5 minutes then make a note of the alarm and clear it by pressing and holding 
- > Let the device go out
- > Contact the installer.

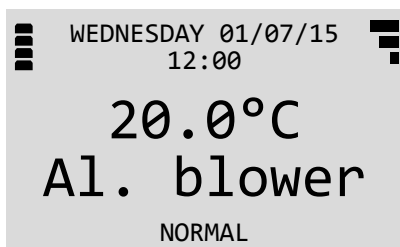

“Extractor” alarm

This alarm indicates a malfunction of the smoke extractor or its speed sensor.

If this alarm is displayed:

- > Wait for 5 minutes then make a note of the alarm and clear it by pressing and holding 
- > Let the device go out
- > Contact the installer.

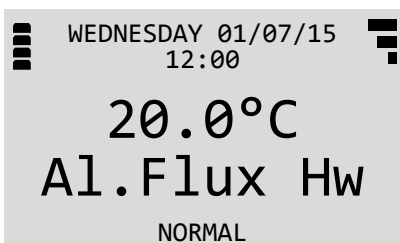

“Hardware flow” alarm

This alarm indicates a flow sensor malfunction.

If this alarm is displayed:

- > Wait for 5 minutes then make a note of the alarm and clear it by pressing and holding 
- > Let the device go out
- > Contact the installer.



“Smoke temperature” alarm

This alarm indicates that a smoke temperature has been measured that is too high.

If this alarm is displayed:

- > Wait for 5 minutes then make a note of the alarm and clear it by pressing and holding 
- > Let the device go out
- > Once the device has gone out and cooled down, remove the ash and empty the ash pan.
- > Check the quality of the pellets being used. If the pellets are too short, the temperature of the smoke will be too high. If you aren't sure, change the pellets.
- > Restart the device. If the alarm starts again, contact the installer.



“Electronic card temperature” alarm

This alarm appears when the electronic card exceeds 70°C.

If this alarm is displayed:

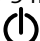
- > Wait for 5 minutes then make a note of the alarm and clear it by pressing and holding 
- > Let the device go out
- > Contact the installer.



“Leak” alarm

This alarm appears when the flow sensor measures a flow rate that is too low.

If this alarm is displayed:

- > Wait for 5 minutes then make a note of the alarm and clear it by pressing and holding 
- > Let the device go out
- > Once the device has gone out and cooled down, remove the ash and empty the ash pan.
- > Make sure the lantern door is closed properly and locked shut. Make sure that the pellet loading valve is closed and no pellets are stuck in its seal. Make sure that the ashpan is right at the back of its housing and properly closed and locked shut. Make sure that the chimney flue and/or the flue outlet are not blocked.
- > Restart the device. If the alarm starts again, contact the installer.

Alarm signals (continued)

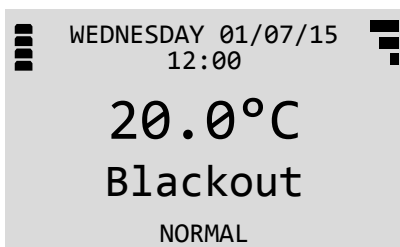

"Blackout" alarm

This alarm occurs when the appliance is deprived of electricity for more than 10 minutes when the stove is operating.

Si cette alarme s'affiche :

- > Wait for 5 minutes then make a note of the alarm and clear it by pressing and holding 
- > Let the device go out
- > Once the device has gone out and cooled down, remove the ash, making sure that **no unburned pellets are left on the burner grille** and empty the ash pan.
- > Restart the device.



"Low pellet" Pre-alarm

This alarm indicates that the level of pellets in the hopper is low.

If the hopper is not reloaded within the period indicated on the remote control, the stove will turn off and will show "pellets empty".

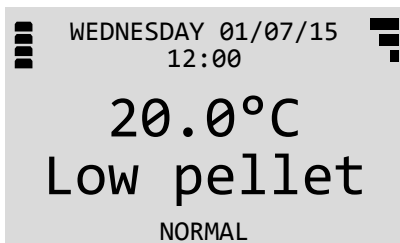

"Out of pellets" alarm

This alarm tells you that the stove is about to go out or has gone out because the pellet hopper is empty.

If this alarm is displayed:

- > Let the device go out
- > Once the device has gone out and cooled down, remove the ash.
- > Fill the pellet hopper before restarting the device.

How to find which software version is installed?

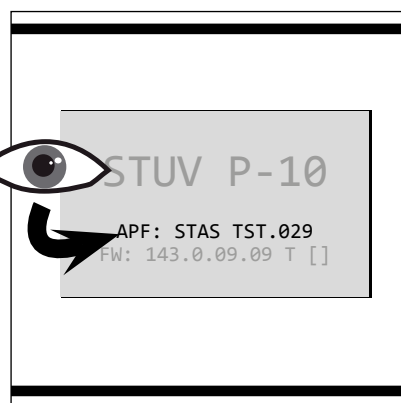
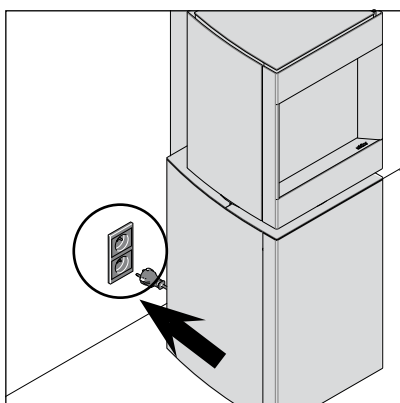

When the appliance is plugged in, the remote control brings up a screen showing the software version installed.

If the version installed is lower than version 29, contact the installer for an update

Location of the serial number

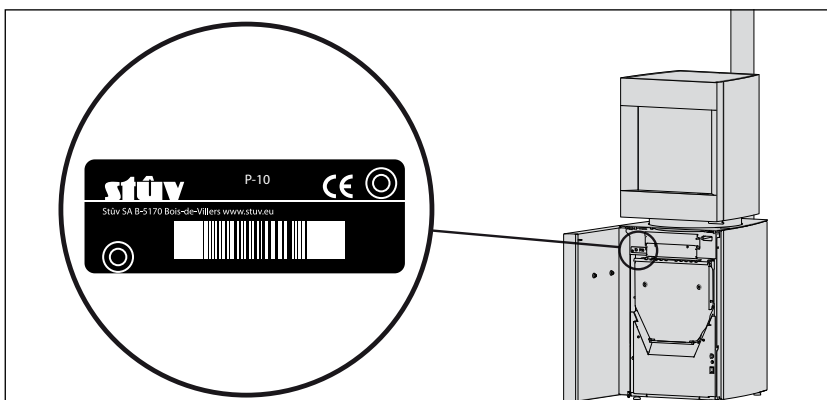

If you encounter a problem or if you notice any deterioration, please contact your installer, telling them the serial number of your appliance.

Product datasheet
EU 2015/1186

stuv

Stûv s.a

Rue Jules Borbouse, 4
B-5170 Bois-de-Villers
info@stuv.com – www.stuv.com

Model reference:

Stûv P-10

Energy efficiency rating	
Direct thermal power	8.0 kW
Indirect thermal power	–
Energy efficiency index	130
Output at rated thermal input	90.5%
Output at minimum capacity	94,5%
<p>Special precautions that must be taken during assembly, installation or maintenance of the decentralised heating device:</p> <p>Consult the installation, usage and maintenance instructions</p>	

DECLARATION OF PERFORMANCE (EU 305-2011)

Stûv P-10

Domestic wood pellet heating appliance
complying with the EN 14785 : 2006 standard
Recommended fuel: Wood pellets only

Manufactured by:

Stûv s.a

Rue Jules Borbouse, 4 B-5170 Bois-de-Villers
Tél: +32(0)81.43.47.96 – Fax: +32(0)81.43.48.74
info@stuv.com www.stuv.com

Notified body:

1881 – IMQ Primacontrol

Via dell'Industria, 55, San Vendemiano TV, Italia

System to assess and check the consistency of performance: 3

Test report number: CPR_15_022

Document number: QA151478501-EN

European standards		EN 14785 : 2006
European standards		Performance
CO emissions	At rated power:	0,001 %
	At reduced power:	0,028 %
Smoke temperature at nominal power		173 °C
Heating power	Nominal:	8 kW
	Distributed in the room:	2.4 kW
	Distributed in water:	- kW
Output	At rated power:	90,5 %
	At reduced power:	94,5 %
Maximum water pressure when operating		-
Surface temperature		Pass
Surface temperature		Pass
Electrical safety		Pass
Mechanical resistance (for the pipe to withstand)		NPD
Fire safety		
Reaction to fire		A1
Minimum distances in relation to combustible materials	Rear insulation thickness	70 mm
	Side insulation thickness	100 mm
	Top insulation thickness	500 mm
	Front insulation thickness	1000 mm
	Insulation thickness in relation to the floor	0 mm
Fire risk after burning fuel has fallen		Pass

The performance of the product identified above is in accordance with the stated performance In accordance with Regulation (EU) No 305/2011, this declaration of performance is drawn up under the sole responsibility of the manufacturer mentioned above.

Bois-de-Villers, 2017

Gérard Pitance



Chief Executive and Founder

Jean-François Sidler



Managing Director and Chief Executive

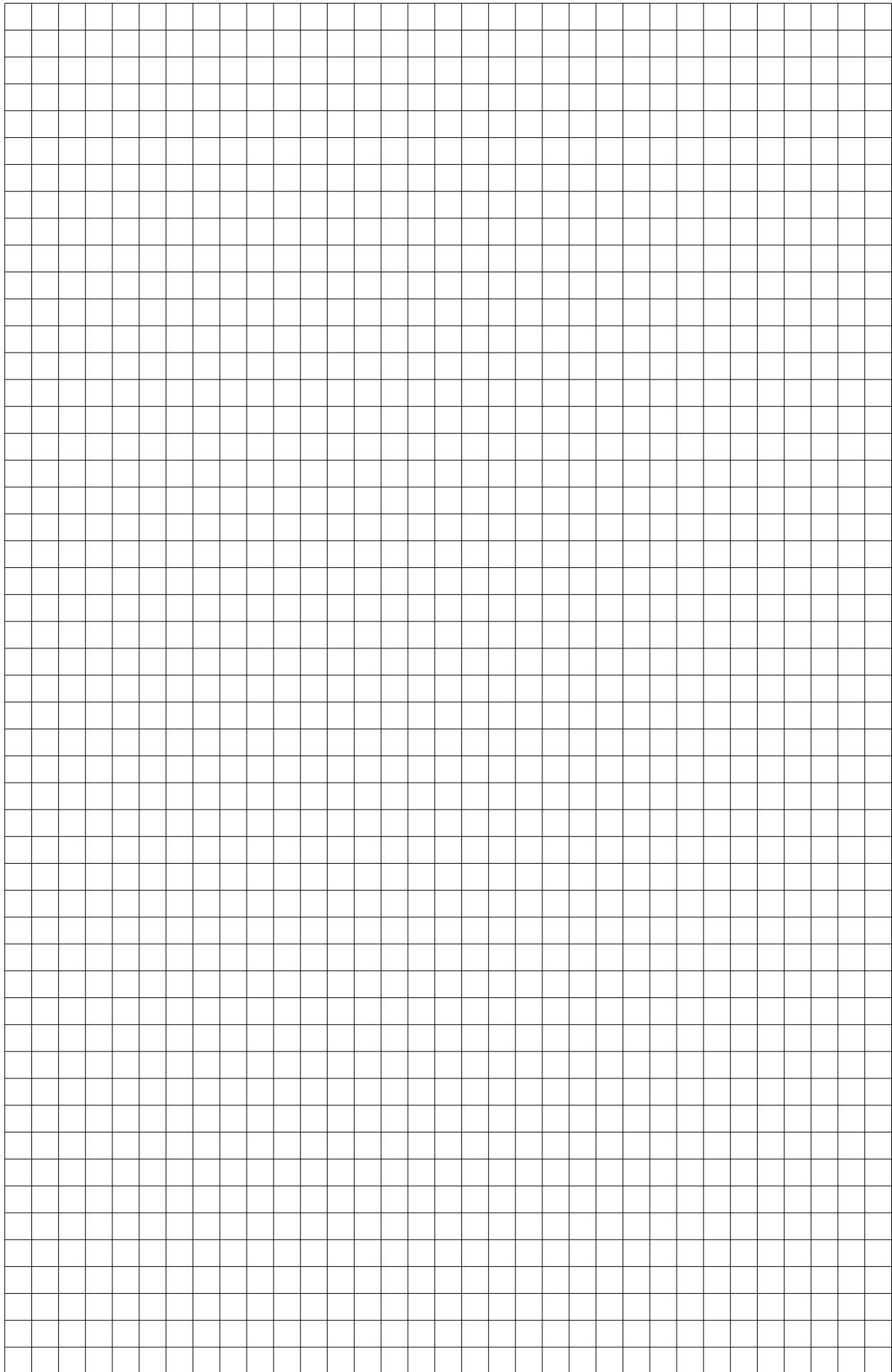

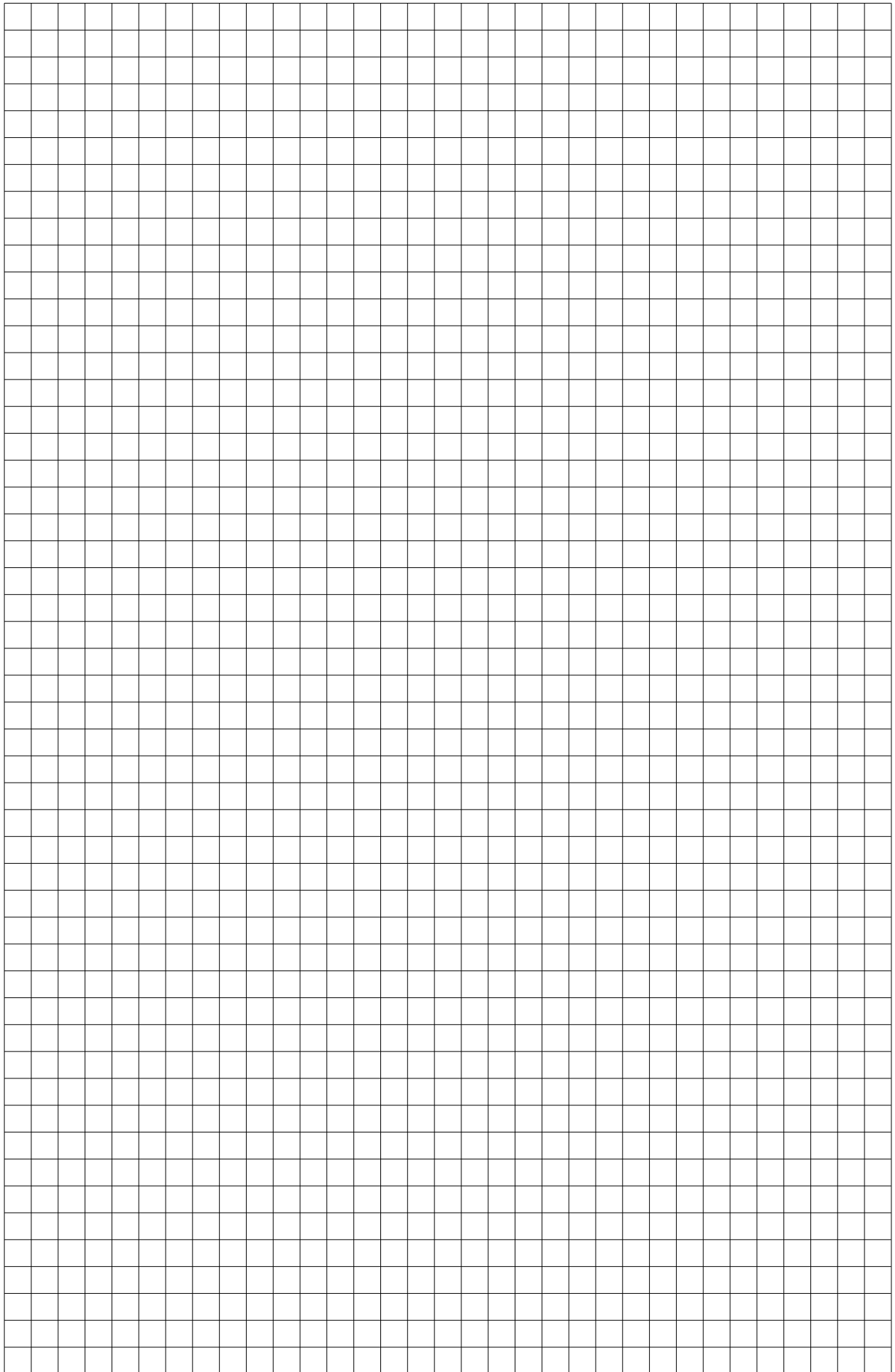

THE EXTENSION OF THE STÛV GUARANTEE: A SIMPLE PROCEDURE FOR MORE PEACE OF MIND.

This fireplace has been designed to offer you maximum pleasure, comfort and safety. Manufactured with great care, from quality materials and components, it will give you satisfaction for many years.

If, despite our best efforts, a fault should occur, we undertake to resolve it.

If you complete the guarantee form within 30 days, Stûv will offer you an extension to the statutory warranty.

Stûv extended warranty

Stûv's extended warranty affects any user of a Stûv appliance (end purchaser). It takes effect on the date of the original sales invoice from the seller to the buyer for new stoves (which have not been subject to being exhibited or used). For second-hand stoves, it will run from the date of the original Stûv sales invoice to the seller.

Duration of the guarantee

The statutory warranty on the components covered is 2 years.

The extended warranty period is:

3 years on the body of the stove

2 years on the electrical and electronic components (fan, thermostat, switch, wiring, etc.)

3 years on other components (base grate, door mechanism, hinges, pulleys, runners, clasps,...)

The right to benefit from extension of the guarantee is subject to adherence to the applicable conditions and the accuracy of the information provided to Stûv.

Extended warranty application conditions



1. Have purchased the stove from one of our official resellers. A list of these is available on our website www.stuv.com



2. Complete the online form on <http://tech.stuv.com/en/pellets/warranty/guarantee-extension.html> within 30 days of the date of the invoice for the balance.



Only duly completed forms will be valid.



You will then receive your Stûv warranty certificate, by email, to the address indicated. Keep this document in a safe place. In the event of a problem with your stove, please contact your dealer. You should show them this certificate for the commercial warranty to be effective.



Stûv stoves are guaranteed against:

- manufacturing faults,
- faults with the paintwork on the visible external parts of the stove

The statutory warranty and extended warranty do not cover:

- the components subject to wear and tear (e.g. ash removal grill, vermiculite, seals, flame modeller, control key) which have to be replaced from time to time in normal usage,
- the ash grill stand and stove glass.
- discolouration appearing in the steel after use,
- faults that have occurred during, or that are the total or partial consequence of:



- > failure to comply with the installation, usage and maintenance advice and recommendations,
- > assembly/installation, modification or repair by a third party,
- > installation by an unapproved installer,
- > failure to follow the installation instructions,
- > modifications made by the installer,
- > a lack of maintenance,
- > an external cause such as flooding, lightning, fire etc.,
- > the use of an inappropriate fuel (only pellets that comply with the Enplus/DINplusA1 norm are appropriate). Please refer to the operating instructions.
- > an obstruction, even if only partial, of the air supply inlet or smoke outlet,
- > an inappropriate smoke duct for installation.

- heat cracks usually appearing in the surrounding walls,

The guarantee is restricted to the exchange of components recognized as defective excluding replacement, compensation and interest costs. The replacement components supplied under the guarantee are guaranteed for the remainder of the guarantee period.

Your responsibility

* extension of the legal guarantee (of 2 years) to 3/2/3 years subject to adherence to the applicable conditions (see box)

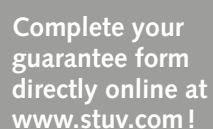

- that you entrust installation (or that you entrust check-over) to a qualified professional who is able, in particular, to check that the characteristics of the smoke flue are appropriate for the stove installed and to ensure that installation meets national and regional requirements in this field ;
- read the user manual carefully and follow the instructions for maintenance;
- have the flue swept regularly to ensure optimal operation. We recommend sweeping at least once or twice a year and definitely before relighting the stove after a long period of inactivity either in general or just before the season when heat is required.

As a consumer, you have legal rights under national legislation in force governing the sale of consumer goods. Your rights are not affected by this commercial guarantee.

This image shows a full page of blank graph paper. The grid consists of thin, light gray horizontal and vertical lines that intersect to form small squares across the entire page. There are no margins, text, or other markings present.

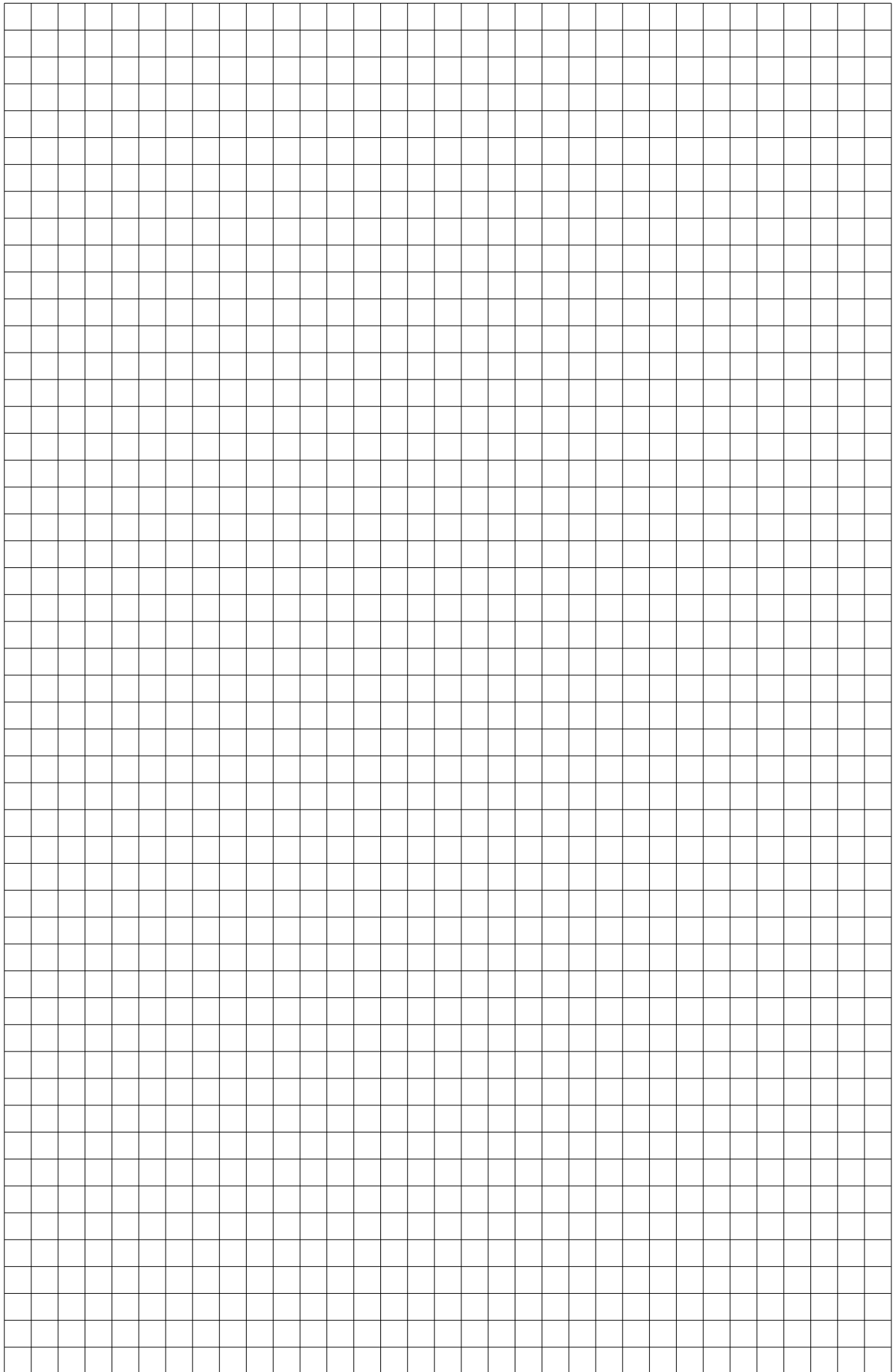

CONTACTS

**Stûv stoves are designed and
manufactured in Belgium by:**

Stûv sa
rue Jules Borbouse 4
B-5170 Bois-de-Villers (Belgium)
info@stuv.com – www.stuv.com

Stûv reserves the right to make changes without prior notice.
These instructions have been produced with the greatest of care.
However, we do not accept responsibility for any errors that may have been made.
Editor: Gérard Pitance - rue Jules Borbouse 4 - 5170 Bois-de-Villers - Belgium

93104740 - directions for use - Stûv P-10

[nl] [de] [it] [es] [pt] [cz] [en] [fr] >
This document is available in several languages:
Contact your distributor or visit www.stuv.com
